

**LOS ANGELES COUNTY**  
**DEPARTMENT OF PUBLIC WORKS**  
**BENCH MARK LIST**



**LANCASTER WEST QUAD**

**1998 ADJUSTMENT**

**NAVD 88 DATUM**  
**METRIC**

## PREFACE

The Department of Public Works level net is composed of more than 1,700 miles (2720 kilometers) of levels supporting in excess of 9,000 bench marks. Previously when a major readjustment of the net was undertaken, the CY, CG, & CL series bench marks were re-labeled DY, DG, & DL, respectively.

Beginning in 1993, the baseline readjustment year will be indicated on baseline BM'S only, as indicated below (\*). Henceforth, all BM numbers will be labeled as a Y, G, or L, series. This designation will no longer indicate the major adjustment year.

To facilitate the adjustment, indexing and distribution of adjusted values of the net, the county territory was divided into 33 quads or areas. For identification purposes, each quad was given a name, i.e., "Rošemead", "La Mirada", "Santa Fe", etc. When bench marks and elevations in these quads are used, the name must be included in the bench mark description as shown below,

\* BASELINE 90.057 L&BR IN CTR OF CB RET @ NE COR LA HABRA BLVD Y 9191  
(1990) 295.461 & VALLEY HOME AVE 10.7M N & 10.7. E/O C/L INT

Updating constrained adjustments will continue in the future. When a quad is readjusted, new elevations will be published and the date of readjustment will be noted in the bench mark description. Two bench marks with different adjustment dates will not normally agree with each other.

The basic accuracy of the net is reflected by an indicated field probable error of plus or minus 0.004mm per kilometer of leveling as determined from the conditions of closure. However, many years of experience in vertical control in the greater Los Angeles basin and Antelope Valley indicate that because of varying subsidence and heaving, the true datum is recovered only by obtaining substantial agreement from a number of different bench marks.

The users of this net are invited to assist in its maintenance by notifying this department in cases of obliteration, apparent mistakes in description or elevations, and proven disturbance of bench marks.

---

---

DATUM: North American Vertical Datum of 1988 (NAVD88)

NAVD 1988 Datum minus approximately 900mm (3.00ft) equals previous NGVD 1929 1929 Datums. For more accurate equations at individual bench marks refer to previous publications.

ABBREVIATIONS USED IN BENCH MARK LISTINGS

ABUT -----	Abutment	ECR -----	End of Curb Return
ALG -----	Along	EC -----	End of Curve
ANG PT -----	Angle Point	ENT -----	Entrance
B/W -----	Back of Walk	FL -----	Floor
BCR -----	Beginning of Curb Return	FTG -----	Footing
BC -----	Beginning of Curve	FRWY -----	Freeway
BLDG -----	Building	F/W -----	Front of Walk
BM -----	Bench Mark	GAR -----	Garage
BT SPK -----	Boat or Bolt Spike	HDWL -----	Headwall
BR CAP -----	Brass or Bronze Cap	HSE -----	House
C B -----	Catch Basin	HWY -----	Highway
CTR -----	Center	INT -----	Intersection
C/L -----	Center Line	IP -----	Iron Pipe
C/L INT -----	Center Line Intersection	LT -----	Left
C/L PROD -----	Center Line Produced	LACE -----	L.A. City Engineer
CONC -----	Concrete	LACS -----	L.A. Co. Engineer
COR -----	Corner	LAFC -----	L.A. Co. Flood Control
COE -----	Corps of Engineers	L&BN -----	Lead and Bench Nail
CULV -----	Culvert	L&BR -----	Lead and Brad
CYN -----	Canyon	L&N -----	Lead and Nail
CB -----	Curb	L&SPK -----	Lead and Spike
CS MON -----	Co. Eng. Monument	L&T -----	Lead and Tack
CT SPK -----	Cut Spike	MCR -----	Middle of Curb Return
DPW -----	Dept. of Public Works	MKD -----	Marked
DR -----	Drive or Driveway	MC -----	Middle of Curve
E/O -----	East of	MON -----	Monument

ABBREVIATIONS USED IN BENCH MARKS (CON'T)

N/O ----- North of  
NR ----- Near  
OPP ----- Opposite  
PI ----- Point of Intersection  
PK&W ----- PK Nail and Washer  
P/L ----- Property Line  
POST ----- Point of Semi-Tangent  
PP ----- Power Pole  
PVMT ----- Pavement  
PROD ----- Produced  
RD ----- Road  
RDBM ----- Road Dept. Bench Mark  
RDBM TAG ----- Road Dept. Bench Mark Tag  
RR ----- Railroad  
RT ----- Right  
R/W ----- Right of Way  
SDMH ----- Storm Drain Manhole  
SMH ----- Sewer Manhole  
SPK ----- Spike  
ST&W ----- Spike Tin and Washer  
S/O ----- South of  
TP ----- Telephone Pole  
USC&GS ----- U.S. Coast and Geodetic Survey  
USGS ----- U.S. Geological Survey  
WK ----- Walk  
W/O ----- West of

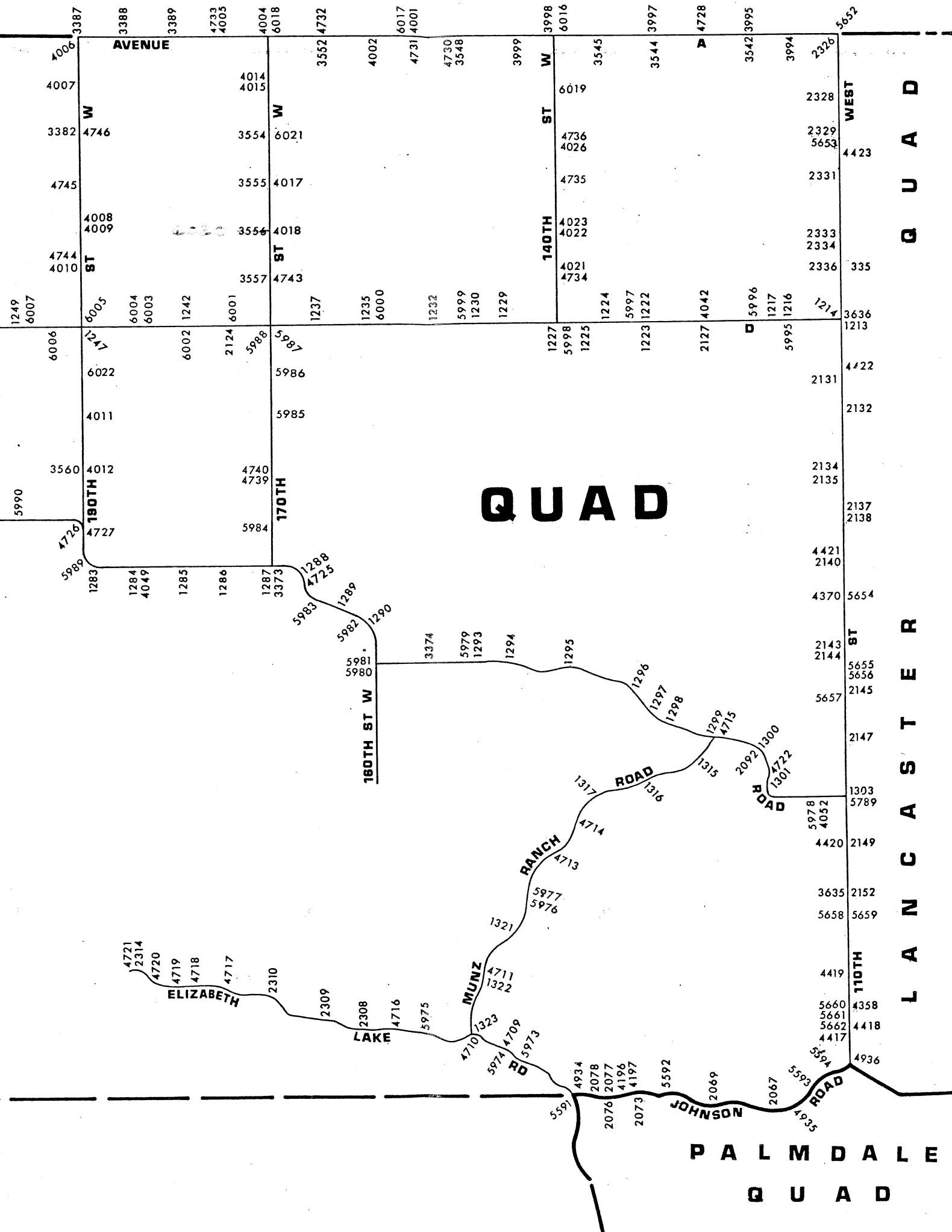

AVENUE

W  
ST

W  
ST

140TH ST W

WEST

QUAD

QUAD

EAST

PALMDALE  
QUAD

1249 6007  
 6006  
 1249 6005  
 6004 6003  
 6002 1242  
 2124 6001  
 5988  
 5987  
 6022  
 4011  
 3560 4012  
 4726  
 5989  
 1283  
 1284 4049  
 1285  
 1286  
 1287 3373  
 1288 4725  
 5983  
 1289  
 5982 1290  
 3374  
 5979 1293  
 1294  
 1295  
 5981 5980  
 180TH ST W  
 3374  
 5979 1293  
 1294  
 1295  
 1296  
 1297  
 1298  
 1299 4715  
 1315  
 2092 1300  
 4722  
 1301  
 1317 ROAD  
 1316  
 1315  
 1315  
 2092 1300  
 4722  
 1301  
 5978 4052  
 4420 2149  
 3635 2152  
 5658 5659  
 4419  
 5660 4358  
 5661  
 5662 4418  
 4417  
 4936  
 5591  
 4934  
 2078  
 2076 2077  
 4196  
 4197  
 2073  
 5592  
 2069  
 2067  
 5593  
 4935  
 JOHNSON ROAD  
 4936  
 3387  
 3388  
 3389  
 4733 4003  
 4004 6018  
 3552 4732  
 4002  
 6017 4001  
 4730 3548  
 3999  
 3998 6016  
 3545  
 3997  
 4728  
 3542 3995  
 3994  
 2326  
 6019  
 4736 4026  
 4735  
 4023 4022  
 4021 4734  
 1227 5998 1225  
 1224  
 5997  
 1223 1222  
 2127 4042  
 5996  
 1217  
 1216  
 1214  
 2328  
 2329 5653  
 2331  
 2333 2334  
 2336  
 335  
 3636 1213  
 4422  
 2131  
 2132  
 2134 2135  
 2137 2138  
 4421 2140  
 4370 5654  
 2143 2144  
 5655 5656  
 2145  
 5657  
 2147  
 1303 5789

C O U N T Y  
C O U N T Y

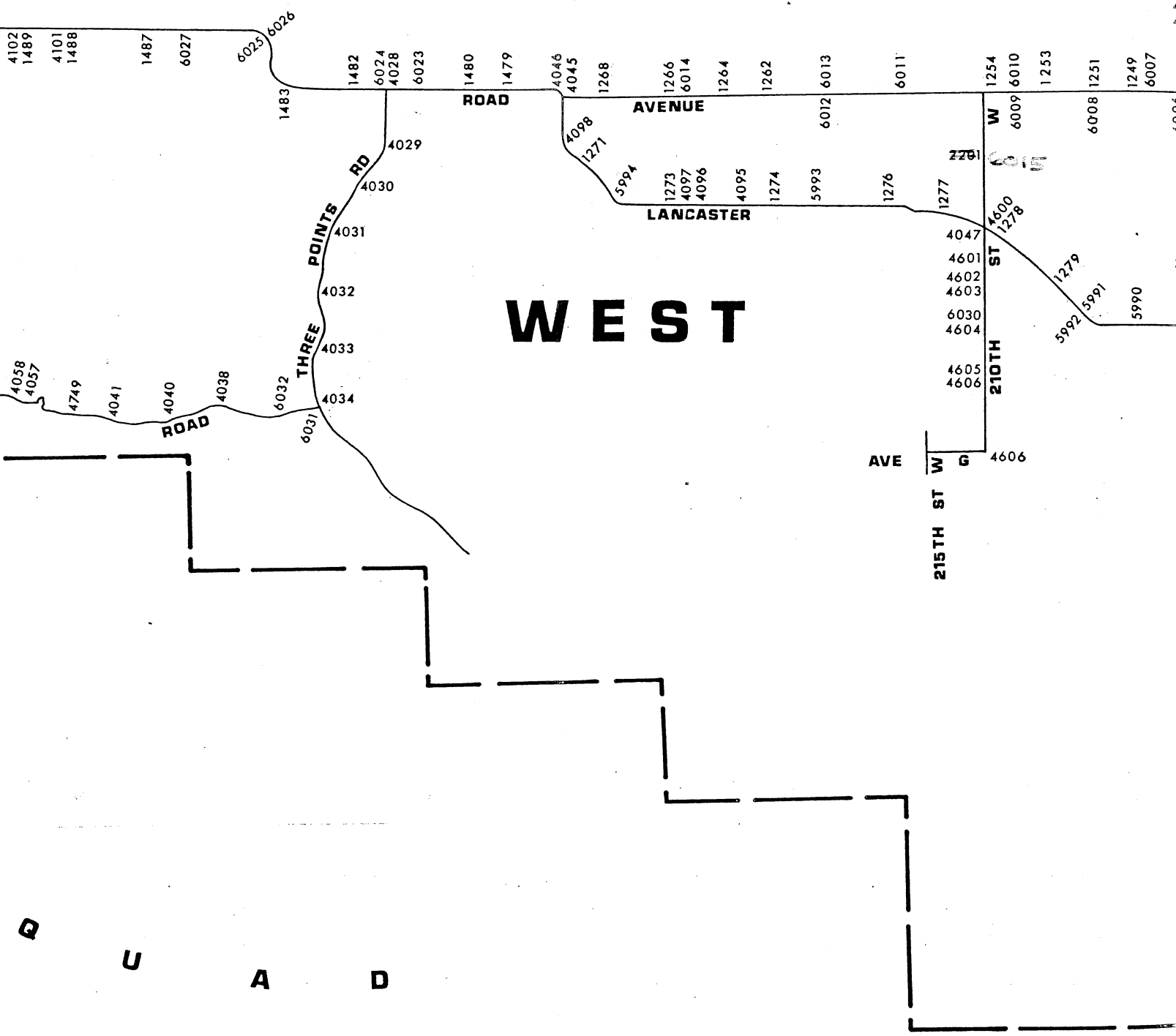

WEST

R  
U  
A  
D

K E R N

C O

A N G E L E S

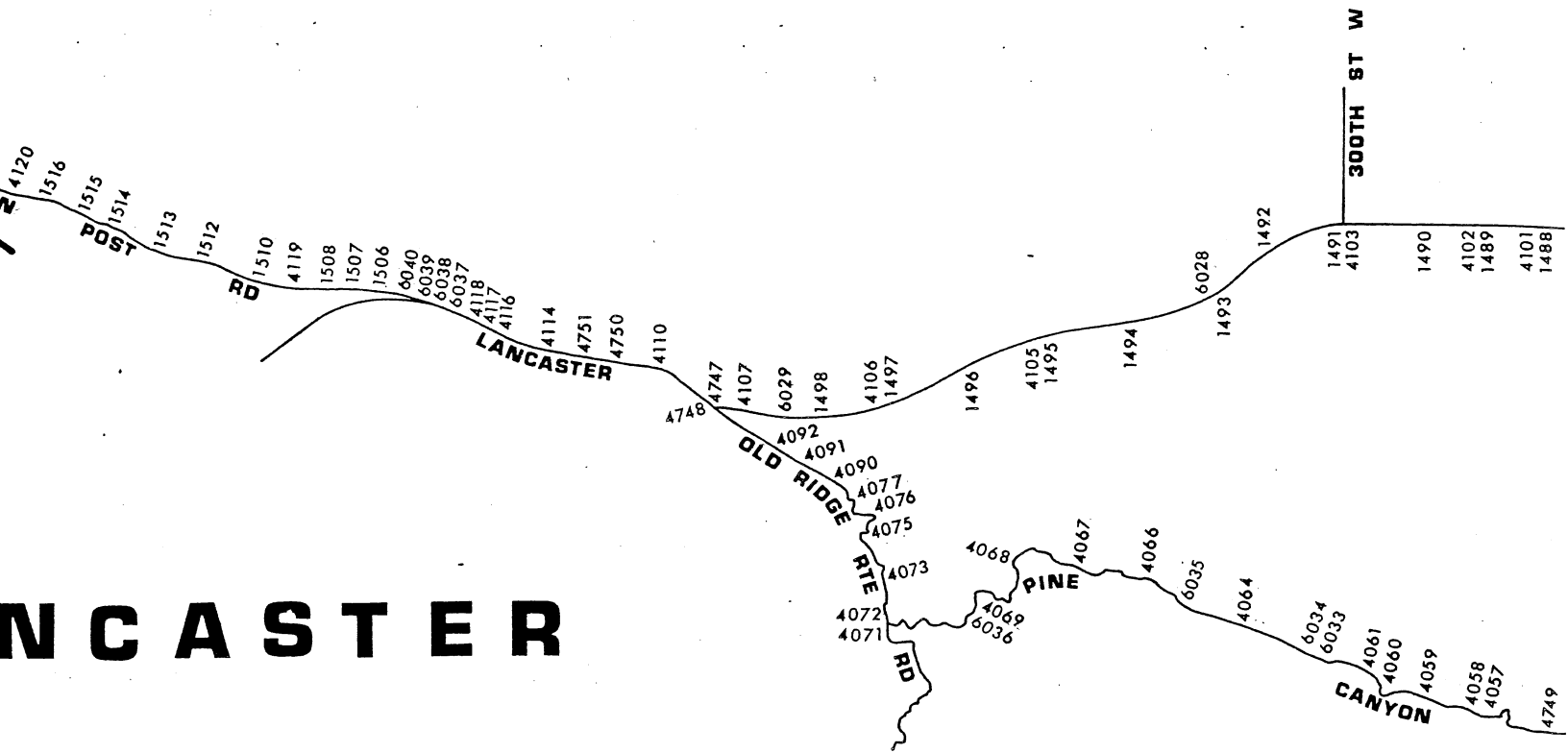

LANCASTER

N E W H A

L

L

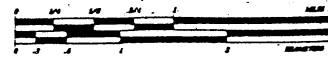

LIGHT SOLID LINES WITHOUT NUMBERS INDICATE PREVIOUS LINES OF BENCH MARKS THAT ARE NOT INCLUDED IN THE 1981 ADJUSTMENT.

D

K E R N  
A N G E L E S

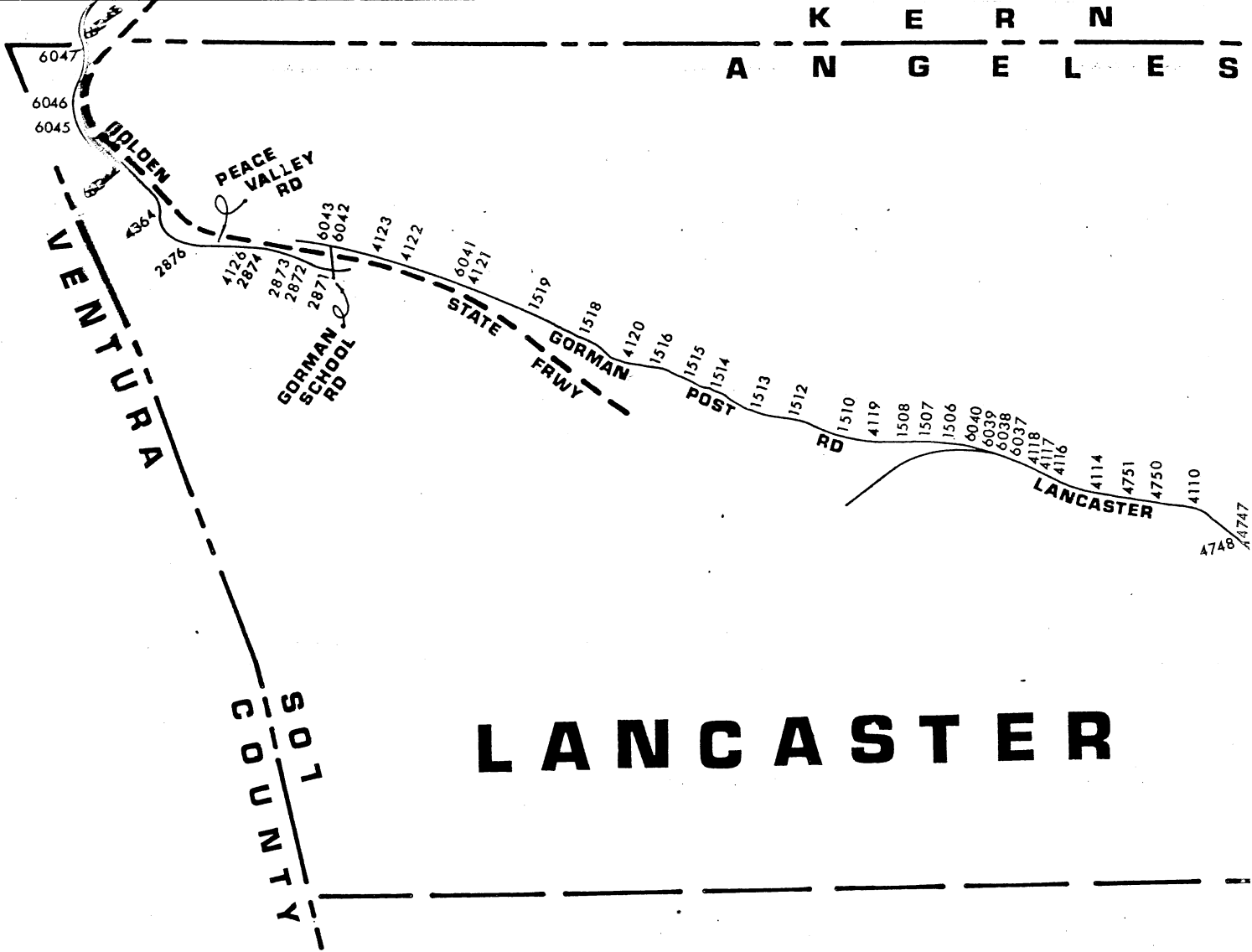

# LANCASTER

N E W H A

LIGHT SOLID LINES WITHOUT NUMBERS INDICATE PREVIOUS LINES OF BENCH MARKS THAT ARE NOT INCLUDED IN THE 1981 ADJUSTMENT.



JAD-YEAR	ELEV METER/FOOT	D E S C R I P T I O N (INCLUDE QUAD AND YEAR IN DESCRIPTION)	BM NUMBER
LANCASTER-W (1998)	0758.396 2488.171	CS MON IN WELL 400MM DN @ C/L INT 110TH ST W & AVE D MKD (CO SUR 13,14,23,23,T8N,R14W)	L 1213
LANCASTER-W (1998)	0759.190 2490.776	RDBM MON IN WELL FL 72M W/O C/L 110TH ST W & 8.5M N/O C/L AVE D 1.8M E/O PP #1218851E MKD (1961) MKR POST 600MM N/O MON	L 1214
LANCASTER-W (1998)	0763.387 2504.546	RDBM MON 2M E/O PP #4244370E 14M N/O C/L AVE D & 59M W/O C/L 115TH ST W (DIRT RD) MKD (1961) MKR POST 600MM N/O MON	L 1216
LANCASTER-W (1998)	0766.985 2516.350	RDBM TAG IN W LEG OF WATER & POWER ELEC TOWER #212-4 43M N & 50M E/O C/L AVE D & 120TH ST W (PROPOSED)	L 1217
LANCASTER-W (1998)	0776.756 2548.407	USC&GS MON IN CONC POST 200MM UP 11M S & 9.4M W/O C/L INT AVE D & 130TH ST W (PROPOSED) MKD (WIND 1952)	L 1222
LANCASTER-W (1998)	0776.655 2548.076	USC&GS MON IN CONC POST 150MM UP 19M S & 9M W/O C/L INT AVE D & 130TH ST W (PROPOSED) MKD (WIND NO 1 1952)	L 1223
LANCASTER-W (1998)	0786.191 2579.362	RDBM TAG IN CONC BASE OF N LEG EDISON TOWER #51-4 61M S/O C/L AVE D & 322M W/O 135TH ST W (PROPOSED)	L 1224
LANCASTER-W (1998)	0784.488 2573.774	RDBM TAG IN CONC BASE OF S LEG OF EDISON TOWER ANTELOPE MAGUNDEN #1 18M N/O C/L AVE D & 322M W/O 135TH ST W (PROPOSED)	L 1225
LANCASTER-W (1998)	0786.411 2580.083	RDBM MON 2M E/O PP #1218923E 14M N C/L AVE D & 47M W/O C/L 140TH ST W MKR POST 600M N/O MON	L 1227
LANCASTER-W (1998)	0791.869 2597.990	RDBM MON 1M E/O PP #2287930E 14M N & 56M W/O C/L AVE D & 145TH ST W MKD (1961) MKR POST 600MM N/O MON	L 1229
LANCASTER-W (1998)	0796.771 2614.073	RDBM MON 1M E/O PP #4306197E 12M N & 58M E/O C/L INT 150TH ST W & AVE D MKD (1961) MKR POST 600MM N/O MON	L 1230
LANCASTER-W (1998)	0801.151 2628.443	RDBM MON 2M W/O PP (NO #) 12M N & 36M E/O C/L INT AVE D & 155TH ST W MKD (1961) MKR POST 600MM N/O MON	L 1232
LANCASTER-W (1998)	0807.708 2649.955	RDBM MON 2M E/O PP #1312422E 8.5M N & 49M W/O C/L INT AVE D & 160TH ST W (DIRT RD) MKR POST 600MM N/O MON	L 1235

JAD-YEAR	ELEV METER/FOOT	DESCRIPTION (INCLUDE QUAD AND YEAR IN DESCRIPTION)	BM NUMBER
LANCASTER-W (1998)	0814.068 2670.821	RDBM MON 2M E/O PP #1312410E 8.5M N & 52M W/O C/L INT AVE D & 165TH ST W (PROPOSED) MKR POST 600MM N/O MON	L 1237
LANCASTER-W (1998)	0833.600 2734.903	RDBM MON IN WELL 3M E/O PP #1312375E 14M N & 14.6M E/O C/L INT AVE D & 180TH ST W (PROPOSED) MKD (1961) MKR POST 600MM N/O MON	L 1242
LANCASTER-W (1998)	0846.246 2776.392	RDBM IN WELL 2.4M E/O PP #1312350E 14M N & 58M W/O C/L INT AVE D & 190TH ST W MKD (1961) MKR POST 600MM N/O MON	L 1247
LANCASTER-W (1998)	0850.918 2791.720	RDBM MON IN WELL 2M E/O PP #1312339 14M N/O & 36.6M W/O C/L INT AVE D & 195TH ST W (PROPOSED) MKD (1961)	L 1249
LANCASTER-W (1998)	0854.772 2804.364	RDBM IN WELL 2M E/O PP (NO #) 14M N & 56M W/O C/L INT AVE D & 200TH ST W MKD (1961) MKR POST 600MM N/O MON	L 1251
LANCASTER-W (1998)	0858.551 2816.763	RDBM MON IN WELL 2M E/O PP #1312315E 14M N & 44M W/O C/L INT AVE D & 205TH ST W (PROPOSED) MKR POST 600MM N/O MON	L 1253
LANCASTER-W (1998)	0859.808 2820.887	RDBM TAG IN CONC FTG OF CHAIN LINK FENCE POST @ SW COR EDISON SUB-STA 15M N & 15M E/O C/L INT AVE D & 210TH ST W (DIRT RD)	L 1254
LANCASTER-W (1998)	0861.804 2827.435	RDBM MON 300MM DN 450MM N/O PP #2287786E 8.5M N & 55M W/O C/L INT AVE D & 225TH ST W (PROP) MKD (1961) MKR POST 600MM N/O MON	L 1262
LANCASTER-W (1998)	0869.389 2852.320	RDBM MON IN WELL 3M E/O PP #4053218E 9M N/O & 52M W/O C/L INT AVE D & 230TH ST W MKD (1961) MKR POST 600MM N/O MON	L 1264
LANCASTER-W (1998)	0879.425 2885.247	RDBM MON IN WELL 700MM NW/O PP #4053216E 55M W & 9M N/O C/L INT AVE D & 235TH ST W MKD (1961)	L 1266
LANCASTER-W (1998)	0891.109 2923.580	RDBM MON IN WELL 4M E/O PP #4053205E 8.5M N & 49M W/O C/L INT AVE D & 240TH ST W MKR POST 600MM N/O MON	L 1268
LANCASTER-W (1998)	0919.877 3017.963	USC&GS MON FLUSH 9M SW C/L LANCASTER RD & 1.1K SE/O AVE D MKR POST 300MM NE MKR SIGN 300MM SLY/O MON MKD (V 305 1935)	L 1271
LANCASTER-W (1998)	0906.891 2975.358	CSBM MON 100MM UP 17M S/O C/L LANCASTER RD & 175M W/O C/L 235TH ST W 7.6M E/O PP #GT8034 MKD (BM 102-55 1957) MKR POST 600MM E/O MON	L 1273

UAD-YEAR	ELEV METER/FOOT	DESCRIPTION (INCLUDE QUAD AND YEAR IN DESCRIPTION)	BM NUMBER
LANCASTER-W (1998)	0898.077 2946.441	CSBM MON 150MM UP 9M N C/L LANCASTER RD & 6.4M W/O C/L 227TH ST W MKD (BM 102-54 1957)	L 1274
LANCASTER-W (1998)	0878.894 2883.505	CSBM MON 150MM UP 10M N/O C/L LANCASTER RD & 966M W/O 210TH ST W MKD (BM 102-52 1957) MKR POST 300MM S/O MON	L 1276
LANCASTER-W (1998)	0884.070 2900.486	CSBM MON 150MM UP 15M N/O C/L LANCASTER RD & 402M W/O C/L 210TH ST W MKD (BM 102-51 1957) 7M E/O C/L DIRT RD 25MM IP MKR 300MM N/O MON	L 1277
LANCASTER-W (1998)	0894.144 2933.537	CSBM MON 150MM UP 15M S/O C/L LANCASTER RD & 585M E/O 210TH ST W MKD (BM 102-50 1957) MKR POST 300MM N/O MON	L 1278
LANCASTER-W (1998)	0901.002 2956.037	USC&GS MON IN TOP OF 200MM CONC POST 350MM UP 9M W/O C/L LANCASTER RD & 805M NWLY 200TH ST W (DIRT) MKD (X-305 1935) MKR POST 300MM E/O MON	L 1279
LANCASTER-W (1998)	0883.561 2898.816	CSBM MON 150MM UP 17M S C/L AVE LANCASTER RD & 25M E/O C/L PROD 190TH ST W 8M E PP #2163801E MKD (BM 102-45 1957) MKR POST 700MM S/O MON	L 1283
LANCASTER-W (1998)	0876.264 2874.876	CSBM MON 100MM UP 15.5M S C/L LANCASTER RD & 36M E/O C/L 185TH ST W (DIRT) 1M N/O PP (NO#) MKD (BM 102-44 1957) MKR POST 600MM N/O MON	L 1284
LANCASTER-W (1998)	0863.962 2834.515	CSBM MON 100MM UP 17M S C/L LANCASTER RD & 4.6M W/O C/L 180TH ST W 1M N/O PP (NO#) MKD (BM 102-43 1957) MKR SIGN 300MM N/O MON	L 1285
LANCASTER-W (1998)	0856.760 2810.887	CSBM MON FLUSH 17.4M S/O C/L LANCASTER RD & 805M W/O 170TH ST W 600MM W/O PP (NO#) MKD (BM 102-42 1957) MKR POST 450MM N/O MON	L 1286
LANCASTER-W (1998)	0849.795 2788.036	CSBM MON 100MM UP 11M S C/L AVE F-8 & 6.4M E/O C/L PROD 170TH ST W MKD (BM 102-41 1957) 700MM NW/O NW PROP FENCE COR	L 1287
LANCASTER-W (1998)	0849.529 2787.163	USGS MON 13M W/O C/L LANCASTER RD (167TH ST W) & 21M S/O C/L PROD AVE F-8 MKD (2786) MKR POST 1M W/O MON	L 1288
LANCASTER-W (1998)	0851.494 2793.610	CSBM MON FLUSH 600MM ABOVE RD GRADE 7.6M N C/L LANCASTER RD & 805M W/O 160TH ST MKD (BM 102-39 1957) MKR SIGN 300MM E/O MON	L 1289

UAD-YEAR	ELEV METER/FOOT	DESCRIPTION (INCLUDE QUAD AND YEAR IN DESCRIPTION)	BM NUMBER
LANCASTER-W (1998)	0849.063 2785.634	CSBM MON 100MM UP 27.4M NE/O C/L 160TH ST W & 644M N LANCASTER RD @ CURVE TO W 9M E PP 699344E MKD (BM 102-38 1957) MKR POST 600MM N/O MON MKR SIGN 300MM W/O MON	L 1290
LANCASTER-W (1998)	0838.753 2751.809	USGS MON 100MM UP 13M S C/L LANCASTER RD & 4.7K W/O MUNZ RANCH RD 21.3M E C/L PROD DIRT RD TO N 24.4M E/O SEC LINE 5,6,T7N,R14W, MKD (R 39 1929)	L 1293
LANCASTER-W (1998)	0817.706 2682.757	CSBM MON FLUSH 34.4M S C/L LANCASTER RD & 3.9K W/O MUNZ RANCH RD ON LEVEL AREA MIDWAY UP A RISE 23M SW/O PP (NO#) MKD (BM 102-34 1957 RE 5869) MKR POST 600MM N/O MON	L 1294
LANCASTER-W (1998)	0800.388 2625.940	CSBM MON 100MM UP 7.6M N/O C/L LANCASTER RD & 2.9K W/O MUNZ RANCH RD 15.5M N/O PP (NO#) 1M W/O FENCE COR MKD (BM 102-33 1957 RE 5869)	L 1295
LANCASTER-W (1998)	0794.710 2607.311	CSBM MON FLUSH 7.6M N C/L LANCASTER RD & 1.75K W/O MUNZ RANCH RD NR PI OF CURVE 1M S FENCE POST MKD (BM 102-32 1957 RE 5869) 27.4M W/O PVT ST MKR POST 300MM S/O MON	L 1296
LANCASTER-W (1998)	0788.786 2587.875	USC&GS MON FLUSH 1.2M BELOW RD GRADE 13M S/O C/L LANCASTER RD & 1.1K W/O MUNZ RANCH RD 22M SE/O PP (NO#) MKD (Z 305 1935) MKR 300MM N/O MON	L 1297
LANCASTER-W (1998)	0787.721 2584.381	CSBM MON FLUSH 14M S C/L LANCASTER RD & 805M W/O MUNZ RANCH RD 17M SE/O PP #1559802E MKD (BM 102-30 1957 RE 5869) MKR POST 300MM N/O MON	L 1298
LANCASTER-W (1998)	0783.565 2570.746	CSBM MON FLUSH 8.2M N/O C/L LANCASTER RD & 9M W/O C/L MUNZ RANCH RD 1.2M E/O PP #402818E MKD (BM 102-29 1957 RE 5869)	L 1299
LANCASTER-W (1998)	0773.664 2538.263	CSBM MON 100MM DN 13M N C/L LANCASTER RD & 71M W/O 120TH ST W MKD (102-28 1958 RE 5869) BUTTON GONE MKR 600MM S/O MON NR MI MKR #12.03	L 1300
LANCASTER-W (1998)	0777.059 2549.401	CSBM MON FLUSH 7.6M N C/L PROD AVE I & 17M E/O C/L PROD 120TH ST W 15M SE/O PP #3002085E MKD (BM 102-27 1957 RE 5869) BUTTON GONE	L 1301
LANCASTER-W (1998)	0762.058 2500.185	CS MON IN WELL 450MM DN ON C/L 110TH ST W 1.5M N/O C/L AVE I MKD (CO SUR 11,12,13,14,T7N,R14W, RE 2177)	L 1303

UAD-YEAR	ELEV METER/FOOT	D E S C R I P T I O N (INCLUDE QUAD AND YEAR IN DESCRIPTION)	BM NUMBER
LANCASTER-W (1998)	0789.124 2588.984	CSBM MON FLUSH 10.4M NW/O C/L MUNZ RANCH RD & 644M S/O LANCASTER RD 49M S DIRT DRWY TO HSE # 45715 300MM W/O INT 1.2M BARBED WIRE FENCES MKD (BM 113-8 1960 RE 5869) MKR POST 600MM SE/O MON	L 1315
LANCASTER-W (1998)	0798.762 2620.605	CSBM MON 100MM DN 600MM BELOW PVMT GRADE 7.6M SE/O MUNZ RANCH RD & 1.3K S/O LANCASTER RD MKD (BM 113-7 1960 RE 5869) MKR POST 600MM W/O MON	L 1316
LANCASTER-W (1998)	0816.793 2679.762	CSBM MON FLUSH 9.8M N/O C/L MUNZ RANCH RD & 4.8K N/O ELIZABETH LAKE RD 335M NE/O POWER LINE CROSSING MKD (BM 113-6 1960 RE 5869) MKR 600MM E/O MON	L 1317
LANCASTER-W (1998)	0936.414 3072.218	CSBM MON FLUSH 10M NWLY/O C/L MUNZ RANCH RD & 1.85K N/O ELIZABETH LAKE RD 12M NELY/O MI MKR # #3.26 MKD (BM 113-2 1960) MKR POST 600MM S MON	L 1321
LANCASTER-W (1998)	0986.484 3236.490	CSBM MON 450MM DN 8.2M E/O C/L MUNZ RANCH RD & 952M N/O ELIZABETH LAKE RD 600MM E PP #307253E MKD (BM 113-1 1960 RE 5869) MKR POST 600MM UP 600MM E/O MON	L 1322
LANCASTER-W (1998)	1005.739 3299.662	CSBM MON FLUSH 13.4M E/O C/L MUNZ RANCH RD & 21.6M N/O C/L ELIZABETH LAKE RD 1M N PP #29176M MKD (BM 111-32 1960 RE 5869) MKR 600MM E/O MON	L 1323
LANCASTER-W (1998)	0906.737 2974.853	CSBM MON FL 19M N C/L HWY 138 & 724M W/O 245TH W ON W SIDE DIRT DR TO HSE #24715 3M NW/O PP #1120495E MKD (BM 102-59 1957)	L 1479
LANCASTER-W (1998)	0920.744 3020.808	CSBM MON FL 9M N C/L HWY 138 & 1.5K W/O 245TH ST W 2M W/O PP #1123606E MKD (BM 102-60 1957 RE 5869) MKR SIGN 300MM S/O MON	L 1480
LANCASTER-W (1998)	0931.289 3055.404	CSBM MON FL 9M N/O C/L LANCASTER RD & 563M W/O THREE POINTS RD 2M W/O PP #1123627E MKD (BM 102 -62 1957) MKR POST 600MM W/O MON	L 1482
LANCASTER-W (1998)	0930.917 3054.184	CSBM MON FL 21M S C/L LANCASTER RD & 127M E/O C/L 269TH ST W OPP HSE #26803 2M E/O C/L PROD OF DRWY MKD (BM 102-63 1957 RE 5869) MKR SIGN 150MM N/O MON	L 1483
LANCASTER-W (1998)	0926.658 3040.210	CSBM MON 75MM UP 15M S C/L LANCASTER RD @ 280TH ST W 1M W/O PP #1122597E MKD (BM 102-66 1957) USC&GS MKR SIGN 300MM N/O MON	L 1487

UAD-YEAR	ELEV METER/FOOT	D E S C R I P T I O N (INCLUDE QUAD AND YEAR IN DESCRIPTION)	BM NUMBER
LANCASTER-W (1998)	0928.550 3046.418	CSBM MON FL 15M S/O C/L LANCASTER RD & 58M W/O C/L MARAGLO ST (DIRT RD) 1M W/O PP #1123690E MKD (BM 102-67 1957) MKR SIGN 300MM N/O MON	L 1488
LANCASTER-W (1998)	0921.622 3023.688	USC&GS MON 250MM DN 15M S/O C/L LANCASTER RD & 37M E/O C/L 290TH ST W (DIRT) 25M E PP 1123700E MKD (T 305 1935) MKR POST 300MM N/O MON	L 1489
LANCASTER-W (1998)	0928.136 3045.060	CSBM MON FL 15M S C/L HWY 138 & 805M E/O 300TH ST W 1M W/O PP #4053165E 75M E/O C/L DRWY TO HSE #29826 MKD (BM 102-69 1957)	L 1490
LANCASTER-W (1998)	0928.772 3047.146	CSBM MON FL 15M S/O C/L HWY 138 & 66M E/O C/L 300TH ST W OPP HSE #29853 1M W/O PP #1123722E MKD (BM 102-70 1957) USC&GS MKR 300MM N/O MON	L 1491
LANCASTER-W (1998)	0942.261 3091.401	CSBM MON FL 15M NW C/L HWY 138 & 966M W/O 300TH ST W 3M N/O PP #1049047E 1.5M SW/O FENCE COR MKD (BM 102-71 1957) MKR SIGN 300MM S/O MON	L 1492
LANCASTER-W (1998)	0952.951 3126.473	CSBM MON 150MM UP 15M S C/L HWY 138 & 5.5K E/O OLD RIDGE RTE 1.7K W/O 300TH ST W NR N&S PP LINE MKD (BM 102-72 1957) USC&GS MKR 300MM N/O MON	L 1493
LANCASTER-W (1998)	0959.193 3146.952	CSBM MON FL 15M S/O C/L HWY 138 & 4.5K E/O OLD RIDGE RTE 6M S/O S END HDWL CULV #156+09 MKD (BM 102-73 1957) USC&GS MKR 300MM N/O MON	L 1494
LANCASTER-W (1998)	0966.965 3172.451	CSBM MON 150MM UP 15M S/O C/L HWY 138 & 3.8K E/O OLD RIDGE RTE 5.5M S/O S END CULV #A133+60 MKD (BM 102-74 1957) MKR POST 450MM E/O MON	L 1495
LANCASTER-W (1998)	0979.346 3213.071	CSBM MON 100MM UP 15M S C/L LANCASTER RD (HWY 138) 5M S/O S END CONC HDWL & 2.9K E/O OLD RIDGE RTE RD MKD (BM 102-75 1957) MKR 300MM N/O MON	L 1496
LANCASTER-W (1998)	0997.930 3274.042	USC&GS MON FL 15M N/O C/L HWY 138 & 2.2K E/O OLD RIDGE RTE 147M E/O CULV #75+78 & 23M E/O PP (NO #) MKD (R 305 1935) MKR 30MM S/O MON	L 1497
LANCASTER-W (1998)	1018.778 3342.441	CSBM MON 150MM UP 15M S C/L HWY 138 & 1.2M E/O OLD RIDGE RTE 5M S/O S END CONC HDWL CULV #51+ 15 MKD (BM 102-77 1957) USC&GS MKR 300MM N/O MON	L 1498
LANCASTER-W (1998)	1017.573 3338.487	USC&GS MON 150MM UP 11M S/O C/L GORMAN POST RD 2M N/O PP #1699201E 161M W/O INT LANCASTER RD MKD (Q 452 1953) METAL MKR POST 600MM N/O MON	L 1506

UAD-YEAR	ELEV METER/FOOT	D E S C R I P T I O N (INCLUDE QUAD AND YEAR IN DESCRIPTION)	BM NUMBER
LANCASTER-W (1998)	1032.097 3386.138	USC&GS MON 200MM UP 29M SE/O C/L GORMAN POST RD & 644M W/O INT LANCASTER RD ON SW SIDE OF SMALL HILL @ MI MKR #0.50 MKD (Z 53 1926 RESET 1953) MKR POST 600MM W/O MON	L 1507
LANCASTER-W (1998)	1036.975 3402.142	USC&GS MON 1M W/O E END N HDWL OF CULV 6.4M N C/L GORMAN POST RD & 805M W/O LANCASTER RD MKD (P 452 1953) @ MI MKR #0.60	L 1508
LANCASTER-W (1998)	1093.712 3588.287	USC&GS MON 150MM UP 15M NE C/L GORMAN POST RD 1.8K W/O LANCASTER RD 7.3M S C/L DIRT RD TO E MKD (B 370 1953) MKR POST 600MM NW/O MON	L 1510
LANCASTER-W (1998)	1062.315 3485.278	USC&GS MON 300MM W/O E END S HDWL OF CULV #1.80 8.5M S/O C/L GORMAN POST RD 2.6K W/O LANCASTER RD MKD (1 452 1953)	L 1512
LANCASTER-W (1998)	1055.237 3462.057	USC&GS MON 100MM UP 12.5M S C/L GORMAN POST RD & 2.9K W/O LANCASTER RD 9M SW/O S END OF CULV #2.00 MKD (A 370 1953) MKR POST 450MM W/O MON	L 1513
LANCASTER-W (1998)	1062.191 3484.872	USC&GS MON 150MM UP 13M S/O C/L GORMAN POST RD 3.2K W/O LANCASTER RD NR POWER LINE CROSSING 15M W/O NW END OF S HDWL OF CULV #2.20 MKD (K 452 1953) MKR POST 455MM NW/O MON	L 1514
LANCASTER-W (1998)	1063.338 3488.635	USC&GS MON 150MM UP 9.4M S/O C/L GORMAN POST RD 3.7M W/O LANCASTER RD 14.3M W/O PP #25-41 MKD (J 452 1953) MKR POST 400MM W/O MON	L 1515
LANCASTER-W (1998)	1071.713 3516.112	USC&GS MON 150MM UP 11M SW C/L GORMAN POST RD & 4.2K W/O LANCASTER RD 21M SE/O END OF S HDWL OF CULV #2.90 4.6M W/O PP #15-41 MKD (A 54 1926) MKR POST 450MM E/O MON	L 1516
LANCASTER-W (1998)	1085.593 3561.650	USC&GS MON 150MM UP 12M NE C/L GORMAN POST RD & 3.1MI W/O LANCASTER RD 24M SE/O PP (NO#) MKD (G 452 1953) MKR POST 500MM SE/O MON	L 1518
LANCASTER-W (1998)	1098.261 3603.211	USC&GS MON 150MM UP 15M N/O C/L GORMAN POST RD 2.4K E/O GORMAN SCHOOL RD 600MM W/O SE COR FENCE AROUND EDISON GORMAN SUB-STA 13M NE/O PP (NO #) MKD (F 452 1953) MKR POST 500MM W/O MON	L 1519
BASELINE (1998)	0974.092 3195.834	RDBM TAG IN CONC & ROCK HDWL 4.6M N/O APPROX C/L JOHNSON RD & 2.2K E/O LIMERIDGE DR 2M W/O MI MKR #11.79	L 2067

JAD-YEAR	ELEV METER/FOOT	D E S C R I P T I O N (INCLUDE QUAD AND YEAR IN DESCRIPTION)	BM NUMBER
BASELINE (1998)	1021.188 3350.348	CSBM MON FLUSH 10.7M N/O C/L JOHNSON RD 26M W/O C/L WLY DRWY TO HES #12215 & 1.5K E LIMERIDGE DR MKD (BM 119-32 1961) MKR PIPE 300MM S/O MON	L 2069
BASELINE (1998)	1054.129 3458.422	CS MON DN 250MM 18.8M S C/L JOHNSON RD & 483M E/O LIMERIDGE DR 15.2M E/I MI MKR #12.94 MKD (SEC COR 28,27,33,34,T7N,R14W) MKR 300MM N MON	L 2073
BASELINE (1998)	1041.850 3418.136	CS MON FL @ FENCE COR 52M W/O LEADHILL DR & 34M S/O C/L JOHNSON RD MKD (1/4 COR 28,33, R14W,T7N) 50MM IP MKR 600MM N/O MON	L 2076
BASELINE (1998)	1039.726 3411.168	DN IN SE CONC LEG OF TOWER #220/6 43M N/O C/L JOHNSON RD & 644M E/O ELIZABETH LAKE RD	L 2077
BASELINE (1998)	1035.801 3398.290	CSBM MON 150MM UP 8.5M N/O C/L JOHNSON RD & 563M E/O ELIZABETH LAKE RD 20M W/O MKR #13.59 MKD (BM 119-35 1961)	L 2078
LANCASTER-W (1998)	0773.392 2537.370	CS MON 350MM DN @ C/L INT 120TH ST W & FUT AVE H-8 MKD (1/4 COR 10,11,R14W,T7N,RE 2177) MKR POST 600MM N/O MON	L 2092
LANCASTER-W (1998)	0828.071 2716.763	CSBM MON 4.6M W & 9M N/O C/L INT 175TH ST W & AVE D MKD (BM 117-39 1961 RE 5869) MKR POST 600MM SE/O MON	L 2124
LANCASTER-W (1998)	0771.383 2530.779	USC&GS MON FLUSH 14M N & 7M E/O C/L INT AVE D & 125TH ST W (DIRT RD) MKD (WIND 1952)	L 2127
LANCASTER-W (1998)	0759.510 2491.826	CSBM MON 300MM DN @ SE COR 110TH ST W & AVE D-8 22M S & 9.8M E/O C/L INT MKD (BM 119-42 1961) MKR POST 600MM W/O MON	L 2131
LANCASTER-W (1998)	0757.184 2484.195	CS MON IN WELL 450MM DN @ C/L INT 110TH ST W & AVE E MKD (SEC COR 23,24,25,25,R14W,T8N)	L 2132
LANCASTER-W (1998)	0761.132 2497.147	CS MON IN WELL 450MM DN @ C/L INT 110TH ST W & AVE E-8 10.7M E/O PP #1222609E MKD (CO SUR 1/4 SEC COR 25,26,T8N,R14W)	L 2134
LANCASTER-W (1998)	0761.764 2499.221	CSBM MON 150MM DN @ SW COR 110TH ST W & AVE E-8 33.5M S & 10M W/O C/L INT MKD (BM 119-44 1961) MKR POST 600MM E/O MON	L 2135
LANCASTER-W (1998)	0767.816 2519.076	CSBM MON FL 79M S/O C/L FUT AVE F & 10.7M W/O C/L 110TH ST W MKD (BM 119-45 1961) MKR POST 700MM E/O MON	L 2137



JAD-YEAR	ELEV METER/FOOT	D E S C R I P T I O N (INCLUDE QUAD AND YEAR IN DESCRIPTION)	BM NUMBER
LANCASTER-W (1998)	0767.410 2517.744	CS MON FL 73M S/O C/L FUT AVE F & 11.6M W/O C/L 110TH ST W MKD (DEL SUR G-1 ECC NO.1 1964)	L 2138
LANCASTER-W (1998)	0760.087 2493.719	CSBM MON FL 73M S/O AVE F-8 & 9M W/O C/L 110TH ST W 25M N/O PP #4194307E MKD (BM 119-46 1961) MKR POST 600MM NE/O MON	L 2140
LANCASTER-W (1998)	0761.178 2497.298	CS MON IN WELL 300MM DN @ C/L INT 110TH ST W & AVE G-8 MKD (1/4 COR 1,2,R14W,T7N)	L 2143
LANCASTER-W (1998)	0762.587 2501.921	CSBM MON 10.7M W/O C/L 110TH ST W & 111M S/O AVE G-8 MKD (BM 119-21 1961) MKR 600MM E/O MON	L 2144
LANCASTER-W (1998)	0761.874 2499.582	CS MON IN WELL 600MM DN @ C/L INT 110TH ST W & AVE H MKD (SEC COR 1,2,11,12,T7N,R14W)	L 2145
LANCASTER-W (1998)	0762.911 2502.984	CS MON IN WELL 300MM DN @ C/L INT 110TH ST W & AVE H-8 MKD (1/4 COR 11,12,T7N,R14W,)	L 2147
LANCASTER-W (1998)	0764.288 2507.502	CS MON IN WELL @ C/L INT 110TH ST W & AVE I-8 MKD (1/4 COR 13,14,T7N,R14W,RE 5869)	L 2149
LANCASTER-W (1998)	0773.717 2538.437	USC&GS MON FLUSH @ SW COR AVE J & 110TH ST W 13.7M W & 12M S/O C/L INT MKD (SUR 1932) MKR POST 330MM W/O MON	L 2152
LANCASTER-W (1998)	1005.423 3298.625	USGS MON 100MM UP 37.5M S C/L ELIZABETH LAKE RD & 1.6K W/O MUNZ RANCH RD MKD (K 19 1929) MKR POST 600MM N/O MON W/O W END PARKING LOT	L 2308
LANCASTER-W (1998)	1002.877 3290.272	CSBM MON 150MM UP 9M N C/L ELIZABETH LAKE RD & 161M W/O CHAPPAREL FOREST DR 10M E MI MKR 18.85 MKD (BM 111-35 1960 RE 5869) MKR 1FT S/O MON	L 2309
LANCASTER-W (1998)	1003.582 3292.585	USC&GS MON 1000MM UP @ GATE POST NE COR DRWY TO 16633 ELIZABETH LAKE RD & ENT TO UNION SCHOOL 23N N & 6M E/O C/L INT MKD (S 975 1964)	L 2310
LANCASTER-W (1998)	0991.273 3252.201	USGS MON 150MM UP 17M N C/L ELIZABETH LAKE RD & 11.3M E/O C/L LAKE HUGHES RD MKD (R 23 1929) MKR POST 900MM S/O MON	L 2314
LANCASTER-W (1998)	0757.978 2486.799	CS MON IN WELL 600MM DN @ C/L INT 110TH ST W & AVE A MKD (35,36,2,1,R14W,T8N,T9N)	L 2326
LANCASTER-W (1998)	0758.591 2488.811	CS MON IN WELL 300MM DN @ C/L INT 110TH ST W & AVE A-8 MKD (1/4 COR 2,1,T8N,R14W)	L 2328
LANCASTER-W (1998)	0757.583 2485.504	CS MON IN WELL 560MM DN @ C/L INT 110TH ST W & AVE B MKD (2,1,11,12,R14W,T8N)	L 2329

UAD-YEAR	ELEV METER/FOOT	D E S C R I P T I O N (INCLUDE QUAD AND YEAR IN DESCRIPTION)	BM NUMBER
LANCASTER-W (1998)	0758.074 2487.114	CS MON IN WELL 400MM DN @ C/L INT 110TH ST W & FUT AVE B-8 MKD (1/4 COR 11,12,R14W,T8N)	L 2331
LANCASTER-W (1998)	0757.811 2486.252	CS MON IN WELL 500MM DN @ C/L INT 110TH ST W & AVE C MKD (11,12,13,14,R14W,T8N)	L 2333
LANCASTER-W (1998)	0758.638 2488.965	CSBM MON 150MM DN @ SE COR 110TH ST W & AVE C 26M S & 8.2M E/O C/L INT MKD (BM 119-39 1961) MKR POST 600MM W/O MON	L 2334
LANCASTER-W (1998)	0757.563 2485.438	CS MON IN WELL 400MM DN @ C/L INT 110TH ST W & AVE C-8 MKD (1/4 COR 14,13,T8N,R14W)	L 2335
LANCASTER-W (1998)	0758.468 2488.407	CSBM MON 150MM UP @ SW COR 110TH ST W & AVE C-8 29M S & 9M W/O C/L INT MKD (BM 119-40 1961) MKR POST 600MM E/O MON	L 2336
LANCASTER-W (1998)	1164.321 3819.943	L&T IN CONC HDWL 18M S & 18M W/O C/L INT PEACE VALLEY RD & GORMAN SCHOOL RD 152M S/O GOLDEN STATE FRWY OVERPASS	L 2871
LANCASTER-W (1998)	1172.384 3846.397	L&BN IN W END OF CONC HDWL 17M S/O C/L PEACE VALLEY RD & 241M W/O GORMAN SCHOOL RD NR MI MKR #3.50 MKD (BM) BRIDGE #3365	L 2872
LANCASTER-W (1998)	1171.704 3844.166	L&BN IN W END OF CONC HDWL 14M N/O C/L PEACE VALLEY RD & 241M W/O GORMAN SCHOOL RD NR MKR #3.50 MKD (BM) BRIDGE #3365	L 2873
LANCASTER-W (1998)	1191.699 3909.766	L&BN 1.5M W/O E END OF CONC HDWL 12M S/O C/L PEACE VALLEY RD & 724M W/O GORMAN SCHOOL RD NR MI MKR #3.20 MKD (BM)	L 2874
LANCASTER-W (1998)	1208.703 3965.553	L&BN IN CTR OF CONC HDWL 17M S/O C/L PEACE VALLEY RD & 1.2K W/O GORMAN SCHOOL RD NR MI MKR #2.24 MKD (BM)	L 2876
LANCASTER-W (1998)	0850.198 2789.358	CS MON FLUSH ON C/L PROD 170TH ST W 120FT S/O C/L AVE F-8 MKD (1/4 COR 35,36,T8N,R15W,RE 5869) MKR POST 600MM NE/O MON	L 3373
LANCASTER-W (1998)	0845.290 2773.256	CSBM MON FLUSH 1.5M E/O PP (NO#) 10.7M S C/L LANCASTER RD & 805M E/O 160TH ST W MKD (BM 102- 36A 1967) MKR POST 1M NE/O MON	L 3374
LANCASTER-W (1998)	0814.616 2672.619	CS MON 150MM DN @ C/L INT 190TH ST W & AVE B MKD (SEC COR 4,3,9,10,T8N,R15W,RE 2177) 1.5M W/O C/L TRAVELED RDWY	L 3382

JAD-YEAR	ELEV METER/FOOT	D E S C R I P T I O N (INCLUDE QUAD AND YEAR IN DESCRIPTION)	BM NUMBER
LANCASTER-W (1998)	0811.984 2663.984	U S GEN LAND OFFICE MON 100MM UP @ C/L INT AVE A & 190TH ST W MKD (33,34,4,3,T8N,T9N R15W,1934) MKR POST 300MM S/O MON	L 3387
LANCASTER-W (1998)	0808.222 2651.642	CS MON @ C/L INT AVE A & 185TH ST W MKD (34,3, T8N,T9N,R15W) MKR POST 300MM S/O MON	L 3388
LANCASTER-W (1998)	0806.127 2644.768	U S GEN LAND OFFICE MON FLUSH @ C/L INT 180TH ST W & AVE A MKD (34,35,3,2,T8N,T9N,R15W,1934) MKR POST 300MM NW/O MON	L 3389
LANCASTER-W (1998)	0765.852 2512.633	CSBM MON 150MM DN @ SW COR AVE A & FUT 120TH ST W 9M S & 15M W/O C/L INT MKD (BM 117-22 1961) MKR POST 600MM N/O MON (NO BUTTON)	L 3542
LANCASTER-W (1998)	0774.456 2540.861	CSBM MON FL @ SW COR AVE A & 130TH ST W 25M S & 8.5M W/O C/L INT MKD (BM 117-24 1961) MKR POST 600MM E/O MON (BENT OVER)	L 3544
LANCASTER-W (1998)	0777.050 2549.372	CS MON IN WELL 440MM DN @ C/L INT AVE A & (FUT) 135TH ST W MKD (1/4 COR 33,4,R14W,T8N,T9N)	L 3545
LANCASTER-W (1998)	0788.409 2586.639	CS MON IN WELL 510MM DN @ C/L INT AVE A & (FUT) 150TH ST W MKD (SEC COR 5,6,32,31,R14W,T8N,T9N)	L 3548
LANCASTER-W (1998)	0796.378 2612.783	CSBM MON 150MM UP @ SE COR FUT 165TH ST W & AVE 12M S & 15M E/O C/L INT MKD (BM 117-31 1961) MKR POST 60MM N/O MON	L 3552
LANCASTER-W (1998)	0800.206 2625.343	CS MON IN WELL 300MM DN @ C/L INT 170TH ST W & AVE B MKD (1,2,11,12,T8N,R15W) 2.4M E C/L RDWY	L 3554
LANCASTER-W (1998)	0806.221 2645.077	CS MON IN WELL 430MM DN @ C/L INT 170TH ST W & (FUTURE) AVE B-8 MKD (1/4 COR 11,12,R15W,T8N, RE 2177) 3M E/O C/L RDWY	L 3555
LANCASTER-W (1998)	0818.263 2684.585	CSBM MON FLUSH @ SE COR 170TH ST W & (FUT) AVE C-8 18M E/O TRAVELED RD WAY & 30M S/O C/L INT MKD (BM 117-37 1961) MKR POST 600MM W/O MON	L 3557
LANCASTER-W (1998)	0869.690 2853.308	CSBM MON 150MM UP @ SW COR 190TH ST W & AVE E-8 28M W & 28M S/O C/L INT MKD (BM 117-45 1961) 35M W/O TRAVELED RD WAY MKR POST 600MM E/O MON	L 3560
LANCASTER-W (1998)	0774.172 2539.929	USC&GS REF MON FL 12.5M S & 33M W/O C/L INT 110TH ST W & AVE J MKD (SUR 2 NO 5 1968)	L 3635
LANCASTER-W (1998)	0759.098 2490.474	CSBM MON 450MM DN @ SW COR 110TH ST W & AVE D 26.5M S & 9M W/O C/L INT MKD (BM 119-41 1961) MKR POST 600MM E/O MON	L 3636

JAD-YEAR	ELEV METER/FOOT	D E S C R I P T I O N (INCLUDE QUAD AND YEAR IN DESCRIPTION)	BM NUMBER
LANCASTER-W (1998)	0761.562 2498.558	CS MON IN WELL 330MM DN @ C/L INT AVE A & (FUT) 115TH S W MKD (1/4 COR 35,2,T8N,T9N,R14W)	L 3994
LANCASTER-W (1998)	0766.229 2513.870	RDBM TAG IN NW LEG OF ELEC TOWER #41-1 15.5M E/O C/L (FUT) 120TH ST W & 20M S/O C/L AVE A	L 3995
LANCASTER-W (1998)	0774.047 2539.519	40MM IP W/CONC PLUG & BRAD FL 15M E & 15M S/O C/L INT AVE A & 130TH ST W MKR POST 600MM W MON	L 3997
LANCASTER-W (1998)	0781.575 2564.217	CS MON IN WELL 400MM DN @ C/L INT AVE A & 140TH ST W MKD (SEC COR 32,33,5,4,T8N,T9N,R14W)	L 3998
LANCASTER-W (1998)	0784.750 2574.634	CS MON IN WELL 300MM DN @ C/L INT AVE A & 145TH ST W MKD (1/4 COR 32,5,T8N,T9N,R14W)	L 3999
LANCASTER-W (1998)	0791.859 2597.957	RDBM TAG IN CONC COLLAR OF IRRIGATION VALVE 10M N C/L AVE A & 11M E/O C/L (FUT) 155TH ST W WOODEN MKR POST 600MM W/O MON	L 4001
LANCASTER-W (1998)	0794.359 2606.159	CS MON IN WELL 400MM DN @ C/L INT AVE A & (FUT) 160TH ST W MKD (SEC COR 36,31,1,6,T9N,T8N,R15W, R14W)	L 4002
LANCASTER-W (1998)	0797.556 2616.648	CS MON 100MM DN 13M S & 13M E/O C/L INT AVE A & 170TH ST W MKD (FAIRMONT BUTTE RM 2 1970 RE 5869) 100MM STEEL FENCE POST 1.5M NW/O MON	L 4004
LANCASTER-W (1998)	0802.052 2631.399	L&BN IN NE COR CONC SLAB OF IRRIGATION PUMP HSE 10.4M E (FUT) 175TH ST W & 57M N/O AVE A	L 4005
LANCASTER-W (1998)	0811.832 2663.485	CS BR CAP MON 100MM UP 13M N & 13M W/O C/L INT AVE A & 190TH ST W MKD (FAIRMONT BUTTE RM 2 1970 ,RE 5869) MKR POST 300MM S/O MON	L 4006
LANCASTER-W (1998)	0813.256 2668.157	RDBM MON IN WELL 9M E/O C/L 190TH ST W & 805M S/O AVE A @ (FUT) AVE A-8 5.5M E/O PP #2038421E	L 4007
LANCASTER-W (1998)	0830.021 2723.161	CS BRASS CAP MON FLUSH 14M N & 14M E/O C/L INT AVE C & 190TH ST W MKD (FAIRMONT BUTTE E-11 RM2 1970 RE 5869) 4.6M E/O PP (NO#)	L 4008
LANCASTER-W (1998)	0830.086 2723.374	CS BR CAP MON 100MM UP 14M N & 14M W/O C/L INT AVE C & 190TH ST W MKD (FAIRMONT BUTTE E-11 RM2 1970 RE 5869) 8M NW/O PP #4339648E	L 4009
LANCASTER-W (1998)	0838.109 2749.696	RDBM MON IN WELL 7.6M W C/L 190TH ST W & 805M S/O AVE C @ (FUT) AVE C-8 1M W/O GUY POLE OPP PP #2109466E MKR POST 600MM N/O MON	L 4010

UAD-YEAR	ELEV METER/FOOT	D E S C R I P T I O N (INCLUDE QUAD AND YEAR IN DESCRIPTION)	BM NUMBER
LANCASTER-W (1998)	0861.410 2826.143	CSBM MON 150MM UP 15M N & 9M E/O INT (DIRT RDS) 190TH ST W & AVE E MKD (BM 117-44A 1972) MKR POST 300MM E/O MON	L 4011
LANCASTER-W (1998)	0868.787 2850.345	CS MON 300MM DN @ C/L INT 190TH ST W & AVE E-8 MKD (1/4 SEC COR 28,27,T8N,R15W,RE 2177) 7.6M W/O C/L TRAVELED RDWY (1M NE/O RD DIR SIGN)	L 4012
LANCASTER-W (1998)	0800.024 2624.745	RDBM TAG IN SW COR OF CONC SLAB 13M N & 32M E/O C/L INT 170TH ST W & (FUTURE) AVE A-8	L 4014
LANCASTER-W (1998)	0799.299 2622.367	CS MON IN WELL 430MM DN @ C/L INT 170TH ST W & (FUTURE) AVE A-8 MKD (1/4 COR 2,1,T8N,R15W)	L 4015
LANCASTER-W (1998)	0806.701 2646.652	50MM IP W/CONC PLUG & CE TAG FLUSH 15M N & 15M E/O C/L INT 170TH ST W & AVE B-8 CHIS X ON NW EDGE MKR POST 600MM E/O MON	L 4017
LANCASTER-W (1998)	0813.268 2668.197	CSBM MON 100MM UP 24.4M S & 12M E C/L INT 170TH ST W & (FUT) AVE C MKD (BM 117-36B 1972 RE 7078) MKR POST 600MM W/O MON (NR C/L PROD DIRT RD W)	L 4018
LANCASTER-W (1998)	0781.155 2562.839	50MM IP W/CONC PLUG & CE TAG 100MM UP 15M N & 15M E/O C/L INT 140TH ST W & (FUT) AVE C-8 MKR POST 300MM W/O MON	L 4021
LANCASTER-W (1998)	0778.649 2554.618	CS BR CAP MON FLUSH 13.4M S & 14M W/O C/L INT 140TH ST W & (FUT) AVE C MKD (FAIRMONT BUTTE RM 2 1970 RE 5869) MKR POST 600MM E/O MON	L 4022
LANCASTER-W (1998)	0778.382 2553.742	CS BR CAP MON FLUSH 13M S & 14M E/O C/L INT 140TH ST W & (FUT) AVE C MKD (FAIRMONT BUTTE RM 1 1970 RE 5869) 2M SE/O PP (NO#) MKR POST 600MM W/O MON	L 4023
LANCASTER-W (1998)	0779.245 2556.573	RDBM TAG IN NE COR CONC PAD OF IRRIGATION PUMP SHED 21M E C/L 140TH ST W & 17M S/O C/L AVE B 7.6M ELY/O PP (NO#)	L 4026
LANCASTER-W (1998)	0930.200 3051.831	RDBM MON IN WELL 17M S & 11M W/O C/L INT THREE POINTS RD & LANCASTER RD MKD (1973) MKR POST 400MM E/O MON	L 4028
LANCASTER-W (1998)	0952.974 3126.549	CSBM MON 7.6M E C/L THREE POINTS RD & 644M S/O LANCASTER RD 600MM E/O PP (NO #) MKD (BM 111-6 1960 RE 5869)	L 4029
LANCASTER-W (1998)	0955.784 3135.768	CSBM MON 7.6M W/O C/L THREE POINTS RD & 1.4K S/O LANCASTER RD 600MM W/O GUY POLE (NO#) N/O DIRT RD TO #48601 MKD (BM 111-60 1960 RE 5869)	L 4030

JAD-YEAR	ELEV METER/FOOT	D E S C R I P T I O N (INCLUDE QUAD AND YEAR IN DESCRIPTION)	BM NUMBER
LANCASTER-W (1998)	0978.028 3208.747	RDBM MON 8M E/O C/L THREE POINTS RD & 2.4K S/O LANCASTER RD 1M W/O PP (NO #) MKD (BM 111-59 1960 RE 5869) MKR POST 600MM W/O MON	L 4031
LANCASTER-W (1998)	0999.330 3278.635	CSBM MON 7M W/O C/L THREE POINTS RD & 3.2K S/O LANCASTER RD 600MM W/O PP #1938415E MKD (BM 111- -58 1960 RE 5869)	L 4032
LANCASTER-W (1998)	1019.600 3345.138	CSBM MON 12.5M W/O C/L THREE POINTS RD & 4K S/O LANCASTER RD 1M N/O PP #1938408E MKD (BM 111- 57 1960 RE 5869) MKR POST 600MM N/O MON	L 4033
LANCASTER-W (1998)	1046.121 3432.149	CSBM MON (BROKEN) 10M E C/L THREE POINTS RD & 8M N/O C/L PINE CYN RD 1M S/O PP #1200318E MKD (BM 111-56 1960 RE 5869) MKR POST 600MM S/O MON	L 4034
LANCASTER-W (1998)	1083.576 3555.032	RDBM MON IN WELL 6M N C/L PINE CYN RD & 1.6K W/O THREE POINTS RD 1.5M W/O PP #2227471E MKD MKD (1973) 600MM N/O MON	L 4038
LANCASTER-W (1998)	1110.802 3644.356	CE MON 5.5M S C/L PINE CYN RD & 2.3K W/O PINE CYN RD 5M NW/O PP #4203554E 179M W SECOMBRE RD MKD (PROP COR RE 5869) MKR POST 600MM NE/O MON	L 4040
LANCASTER-W (1998)	1162.444 3813.785	RDBM MON IN WELL 9M N C/L PINE CYN RD & 7M E/O C/L DRWY TO #27865 (ROYAL OAKS) 3.2K W/O THREE POINTS RD 30M W/O MI MKR #11.66 MKD (1973) MKR POST 600MM S/O MON	L 4041
LANCASTER-W (1998)	0771.473 2531.074	RDBM MON IN WELL 200MM DN 3M E/O PP #1443367E 14M N AVE D & 48M W/O 125TH ST W MKD (1961) MKR POST 300MM N/O MON	L 4042
LANCASTER-W (1998)	0906.538 2974.200	STATE CALIF DWR MON IN N CB CALIF AQUEDUCT 6.4M W/O E END CB 7M N/O C/L AVE D & 119M E/O C/L 245TH ST W MKD (3136A 1971)	L 4045
LANCASTER-W (1998)	0906.636 2974.522	BOLT IN S CB OF CALIF AQUADUCT 7.3M E/O W END CB 7M S/O C/L AVE D & 92M E/O C/L 245TH ST W	L 4046
LANCASTER-W (1998)	0885.863 2906.369	LACS MON 100MM UP 29M N & 13M E/O C/L INT 210TH ST W & LANCASTER RD MKD (NEENACH SCHOOL O-14 RM1 1970) MKR POST 600MM W/O MON	L 4047
LANCASTER-W (1998)	0872.958 2864.030	RDBM TAG 300MM N/O ANGLE PT @ S END HDWL 7M S C/L LANCASTER RD & 161M E/O C/L 185TH ST W NR E P/L HSE #18303	L 4049

UAD-YEAR	ELEV METER/FOOT	D E S C R I P T I O N (INCLUDE QUAD AND YEAR IN DESCRIPTION)	BM NUMBER
LANCASTER-W (1998)	0768.424 2521.071	USC&GS MON FLUSH 600MM E/O PP #2175740E 8.5M N C/L AVE I & 96M E/O C/L 115TH ST W MKD (B 1220 1971) MKR POST 600MM E/O MON	L 4052
LANCASTER-W (1998)	1168.905 3834.982	RDBM TAG IN LARGE ROCK 8M N/O C/L PINE CYN RD & 4.7K W/O THREE POINTS RD ON W SIDE OF PACIFIC CREST TRAIL	L 4057
LANCASTER-W (1998)	1168.896 3834.953	RDBM MON IN WELL 7M S/O C/L PINE CYN RD & 4.7K W/O THREE POINTS RD MKD (1973) MKR POST 600MM N/O MON ON E SIDE OF PACIFIC CREST TRAIL	L 4058
LANCASTER-W (1998)	1167.532 3830.478	RDBM MON IN WELL 7.6M N C/L PINE CYN RD & 5.5K W/O THREE POINTS RD 4M N/O 1M DIA OAK TREE MKD MKD (1973) MKR POST 600MM S/O MON	L 4059
LANCASTER-W (1998)	1210.054 3969.985	RDBM MON IN WELL 8M S C/L PINE CYN RD & 6K W/O THREE POINTS RD 8M E/O C/L DIRT RD TO CAMP GR HORSE TAIL MKD (1973) MKR POST 600MM N/O MON	L 4060
LANCASTER-W (1998)	1209.817 3969.208	RDBM MON IN WELL 8M S C/L PINE CYN RD & 6K W/O THREE POINTS RD 6M W/O DIRT RD TO CAMP GR HORSE TRAIL MKD (1973) MKR POST 600MM N/O MON	L 4061
LANCASTER-W (1998)	1150.021 3773.027	RDBM MON IN WELL 6M S/O C/L PINE CYN RD & 7.9K W/O THREE POINTS RD 3M S/O 1M DIA OAK TREE MKD (1963) MKR POST 600MM N/O MON	L 4064
LANCASTER-W (1998)	1093.613 3587.962	RDBM MON IN WELL 11M N C/L PINE CYN RD & 9.3K W/O THREE POINTS RD 6M S/O PP #1185314E MKD (1973) MKR POST 600MM S/O MON	L 4066
LANCASTER-W (1998)	1087.067 3566.486	RDBM MON IN WELL 7.6M S C/L PINE CYN RD & 10K W/O THREE POINTS RD 11M SE/O MI MKR #15.91 24M E/O PP #1185324E MKD (1973) MKR 600MM N/O MON	L 4067
LANCASTER-W (1998)	1142.795 3749.320	RDBM MON IN WELL 9M W C/L PINE CYN RD & 11.3K W/O THREE POINTS RD MKD (1973) MKR 1M E/O MON	L 4068
LANCASTER-W (1998)	1171.939 3844.937	50MM IP W/RCE TAG #11467 FL 5.5M W/O C/L PINE CYN RD & 12K W/O THREE POINTS RD 7.6M S/O SE COR BARN 600MM SE/O IP FENCE COR MKD (LINE)	L 4069
LANCASTER-W (1998)	1223.139 4012.915	CSBM MON 100MM UP 7.6M W/O C/L OLD RIDGE RTE RD & 6M S/O C/L PINE CYN RD MKD (BM 208-9 1968) 2M S/O STOP SIGN	L 4071
LANCASTER-W (1998)	1222.788 4011.764	RDBM TAG IN CTR CONC HDWL OF C B #2.55 6M W/O C/L OLD RIDGE RTE RD & 8M N/O C/L PINE CYN RD	L 4072

QUAD-YEAR	ELEV METER/FOOT	D E S C R I P T I O N (INCLUDE QUAD AND YEAR IN DESCRIPTION)	BM NUMBER
LANCASTER-W (1998)	1199.490 3935.327	USC&GS MON 75MM UP 15M N C/L OLD RIDGE RTE RD & 724M N/O PINE CYN RD @ WLY TURN-OUT 3K SELY OF LANCASTER RD MKD (D-370 1953)	L 4073
LANCASTER-W (1998)	1166.540 3827.223	CSBM MON IN CONC HDWL OF CULV #1.80 450MM E/O W END 6.4M N/O C/L OLD RIDGE RTE RD & 2.5K SELY LANCASTER RD MKD (BM 208-6 1968)	L 4075
LANCASTER-W (1998)	1154.736 3788.496	CS MON FL 8.5M E C/L OLD RIDGE RTE RD & 2.3K SE LANCASTER RD NR SLY END TURN OUT MKD (LA LIEBRE RANCH E-15 1971 RE 7078) MKR POST 1M W/O MON	L 4076
LANCASTER-W (1998)	1149.715 3772.023	CSBM MON 150MM DN 10M N C/L OLD RIDGE RTE RD & 2.2K SLY OF LANCASTER RD MKD (BM 208-5 1968 RE 5869) MKR POST 600MM E/O MON	L 4077
LANCASTER-W (1998)	1118.990 3671.220	CSBM MON FL 18M S C/L OLD RIDGE RTE RD & 1.6K SELY LANCASTER RD 4M ELY/O 1.5M OAK TREE MKD (BM 208-4 1968) MKR POST 600MM N/O MON	L 4090
LANCASTER-W (1998)	1096.210 3596.482	USC&GS MON 200MM UP 16.5M S C/L OLD RIDGE RTE RD & 1.1K SELY OF LANCASTER RD MKD (X-53 1926) SURVEY MKR 300MM S/O MON	L 4091
LANCASTER-W (1998)	1070.755 3512.969	CSBM MON NR E END CONC HDWL #0.70 7M S/O OLD RIDGE ROUTE ROAD & 805M SELY OF LANCASTER RD MKD (BM 208-2 1968 RE 5869)	L 4092
LANCASTER-W (1998)	0900.986 2955.985	CSBM MON 125MM UP 10.7M N/O C/L LANCASTER RD & 161M E/O 229TH ST W (DIRT) MKD (BM 102-54A 1972) MKR POST 600MM S/O MON	L 4095
LANCASTER-W (1998)	0905.241 2969.945	SPK&L 300MM W/O E END CONC CB OF BRIDGE OVER CALIF AQUEDUCT 4.6M S/O C/L LANCASTER RD & 65M W/O C/L 235TH ST W	L 4096
LANCASTER-W (1998)	0905.420 2970.532	STATE OF CALIF DWR MON 450MM W/O E END CONC WK 76M W/O C/L 235TH ST W & 5M N/O C/L LANCASTER RD MKD (3149-A 1971)	L 4097
LANCASTER-W (1998)	0917.090 3008.819	CSBM MON FLUSH 14M W C/L (LANCASTER RD) 245TH ST W & 644M S/O AVE D NR MI MKR #26.66 NR MOC MKD (BM 102-57A 1972) MKR POST 600MM E/O MON	L 4098
LANCASTER-W (1998)	0927.300 3042.317	RDBM TAG IN CONC HDWL 300MM N/O S END 8M S C/L LANCASTER RD & 241M W/O MARAGLO ST (DIRT) 11M NE/O PP #1123692E MKR POST 1M N/O MON	L 4101



JAD-YEAR	ELEV METER/FOOT	D E S C R I P T I O N (INCLUDE QUAD AND YEAR IN DESCRIPTION)	BM NUMBER
LANCASTER-W (1998)	0921.880 3024.535	RDBM TAG IN CTR CONC HDWL 6.7M S C/L LANCASTER RD & 11M E/O C/L 290TH ST W (DIRT) @ DIRT DRWY TO HSE #29300	L 4102
LANCASTER-W (1998)	0928.813 3047.281	RDBM TAG IN CTR OF CONC HDWL 6.7M S/O C/L LANCASTER RD & 41M W/O C/L 300TH ST W	L 4103
LANCASTER-W (1998)	0966.819 3171.972	RDBM TAG IN NE COR CONC HDWL OF CULV 6.7M S/O C/L LANCASTER RD & 3.9K E/O OLD RIDGE RTE RD	L 4105
LANCASTER-W (1998)	1002.973 3290.587	RDBM TAG IN CTR CONC HDWL #A-75+78 6.7M N C/L LANCASTER RD & 2.1K E/O OLD RIDGE RTE RD 32M E/O PP #1061984E	L 4106
LANCASTER-W (1998)	1039.739 3411.210	USC&GS MON IN E END OF CONC HDWL BRIDGE #53-5 7M N C/L LANCASTER RD & 483M E/O OLD RIDGE RTE RD MKD (H 1044 1960)	L 4107
LANCASTER-W (1998)	1015.300 3331.030	DWR MON 150MM UP 43M S/O C/L LANCASTER RD & 1K W/O OLD RIDGE RTE RD 53M W/O DIRT DR TO #34710 MKD (ORP-7 1968) MKR POST 1M S/O MON	L 4110
LANCASTER-W (1998)	1016.158 3333.845	DWR MON 150MM UP 12M N C/L LANCASTER RD & 3K W/O OLD RIDGE RTE RD 33M W/O AC DR TO STATE OF CAL PROP 5M NW/O PP #1061900E MKD (OC W2 1968) SUR MKR 200MM W/O MON	L 4114
LANCASTER-W (1998)	1015.470 3331.588	USC&GS MON FLUSH 13M N C/L (N BBL) LANCASTER RD 3.5K W/O OLD RIDGE RTE RD 15M W/O PP (NO #) MKD (Z 973 1964 RESET 1965) MKR POST 300MM E MON	L 4115
LANCASTER-W (1998)	1015.697 3332.333	USC&GS MON FL 23.5M N C/L LANCASTER RD (N BBL) & 3.5K W/O OLD RIDGE RTE RD 32M E/O PP #1061891E MKD (X-973 1964 RESET 1965) MKR SIGN 450MM E MON	L 4116
LANCASTER-W (1998)	1015.631 3332.116	USC&GS MON 150MM UP 27M N C/L LANCASTER (N BBL) RD & 3.7M W/O OLD RIDGE RTE RD 19M W/O PP #1061891E MKD (W 973 1964 RESET 1965) MKR SIGN 600MM W/O MON	L 4117
LANCASTER-W (1998)	1014.676 3328.983	USC&GS MON FL 29M N C/L LANCASTER RD (N BBL) & 3.7K W/O OLD RIDGE RTE RD 1M W/O PP #1061890E MKD (V 973-1964 RESET 1965) MKR SIGN 450MM W MON	L 4118
LANCASTER-W (1998)	1068.739 3506.355	CSBM MON 100MM UP 11M N/O C/L GORMAN POST RD & 1.3K W/O LANCASTER RD MKD (BM 102-88A 1968) MKR POST 600MM S/O MON	L 4119

JAD-YEAR	ELEV METER/FOOT	D E S C R I P T I O N (INCLUDE QUAD AND YEAR IN DESCRIPTION)	BM NUMBER
LANCASTER-W (1998)	1081.219 3547.299	USC&GS MON 150MM UP 12M S/O C/L GORMAN POST RD 4.5K W/O LANCASTER RD 9M W/O PP #10-41 MKD (H 452 1953) MKR POST 450MM W/O MON	L 4120
LANCASTER-W (1998)	1112.362 3649.474	USC&GS MON 12M N C/L GORMAN POST RD & 1.6K E/O GORMAN SCHOOL RD 5M NE/O PP (NO#) MKD (E 452 1953) @ FENCE COR MKR SIGN 300MMM W/O MON	L 4121
LANCASTER-W (1998)	1143.308 3751.003	RDBM TAG IN CONC WALL OF DROP INLET #4.70 5M N C/L GORMAN POST RD & 805M E/O GORMAN SCHOOL RD 5M W/O PP #1699131E	L 4122
LANCASTER-W (1998)	1153.832 3785.530	USC&GS MON 550MM UP 27M N/O C/L GORMAN POST RD & 483M E/O GORMAN SCHOOL RD 4M SWLY/O PP (NO#) INSIDE DPW MAINTENANCE YD S END MKD (Z 368 1953)	L 4123
LANCASTER-W (1998)	1191.710 3909.802	USC&GS MON IN CONC HDWL #3.20 300MM E/O W END 14.6M S/O C/L PEACE VALLEY RD & 724M W/O GORMAN SCHOOL RD MKD (N 1219 1971)	L 4126
BASELINE (1998)	1042.755 3421.105	RD BM TAG IN E CB @ BCR NE COR JOHNSON RD & LEADHILL DR 15.5M N & 4.9M E/O C/L INT	L 4196
BASELINE (1998)	1060.961 3480.836	RDBM TAG IN E CB NR BCR NE COR JOHNSON RD & LEADHILL DR 14M N & 6.1M E/O C/L INT	L 4197
LANCASTER-W (1998)	0816.585 2679.079	RDBM MON IN WELL 150MM DN 15M N & 18.3M E/O C/L INT 110TH ST W & AVE K MKD (BM 1974) MKR POST 600MM S/O MON	L 4358
LANCASTER-W (1998)	1275.272 4183.955	CSBM MON @ SW COR BRIDGE #53-1779 OVER (5 FRWY) 18M ELY/O C/L PEACE VALLEY RD & 2.1K S/O FRAZIER MTN PARK RD MKD (102-107 1968 RE 5869)	L 4363
LANCASTER-W (1998)	1249.299 4098.742	CSBM MON IN SLY CONC HDWL 600MM E/O C/L W END 16M ELY/O C/L PEACE VALLEY RD 2.6K S/O FRAZIER MTN PARK RD @ MI MKR #1.56	L 4364
LANCASTER-W (1998)	0760.944 2496.530	50MM IP W/CONC PLUG & CS TAG FL @ SE COR AVE G & 110TH ST W 15M S & 15M E/O C/L INT	L 4370
LANCASTER-W (1998)	0854.750 2804.292	CSBM MON 150MM UP 18.6M W C/L 110TH ST W & 805M S/O AVE K 1.8M W PP #2100837E MKD (119-28 1972)	L 4417
LANCASTER-W (1998)	0849.833 2788.160	CALIF DIV OF HWY MON 100MM UP 16M W C/L 110TH ST W & 563M S/O AVE K MKD (DEL SUR G10 1972) MKR POSTS 1M N/O MON & 1.2M S/O MON	L 4418

JAD-YEAR	ELEV METER/FOOT	D E S C R I P T I O N (INCLUDE QUAD AND YEAR IN DESCRIPTION)	BM NUMBER
LANCASTER-W (1998)	0788.768 2587.816	CSBM MON 100MM UP 19.5M S & 18M W/O C/L INT AVE J-8 & 110TH ST W MKD (119-26A 1972) MKR POST 300MM E/O MON	L 4419
LANCASTER-W (1998)	0764.367 2507.761	CSBM MON FL 17M E/O C/L 110TH ST W & 106M S/O AVE I-8 MKD (119-24A 1972) MKR POST 600MM E MON	L 4420
LANCASTER-W (1998)	0759.710 2492.482	40MM IP W/CONC PLUG & BR 150MM DN 16M W C/L INT 110TH ST W & AVE F-8 20.8M SWLY/O PP #1222583 MKR POST 3M S/O MON (USE NW EDGE)	L 4421
LANCASTER-W (1998)	0758.517 2488.568	CS MON IN WELL 250MM DN @ C/L INT 110TH ST W & AVE D-8 MKD (1/4 COR 23,24,T8N,R14W,RE 7078)	L 4422
LANCASTER-W (1998)	0758.361 2488.056	RDBM MON IN WELL 100MM DN 52M N & 12.5M W/O C/L INT 110TH ST W & AVE B-8 2M W/O PP #1222691 MKD (1974) MKR POST 600MM W/O MON	L 4423
LANCASTER-W (1998)	0886.254 2907.652	CS MON IN WELL @ C/L 210TH ST W & 15M N/O C/L LANCASTER RD MKD (19,20,30,29,R15W,T8N,RE 2177)	L 4600
LANCASTER-W (1998)	0901.015 2956.080	RDBM TAG IN SE COR SLAB OF MOST WLY PICNIC AREA SHELTER 111M E C/L 210TH ST W & 30.5M N/O C/L BIKE PATH ON N SIDE CALIF AQUEDUCT	L 4601
LANCASTER-W (1998)	0904.341 2966.992	L&BN IN CONC BASE OF WIRE FENCE POST ON S SIDE CALIF AQUEDUCT 2.8M E/O GATE 56M N/O AVE E-8 & 12M E/O 210TH ST W	L 4602
LANCASTER-W (1998)	0905.250 2969.974	CS MON DN 300MM @ C/L INT 210TH ST W & AVE E-8 MKD (1/4 COR 30,29,T6N,R15W,RE 2177) MKR POST 600MM SE/O MON (9M W/O WIRE FENCE)	L 4603
LANCASTER-W (1998)	0931.864 3057.290	CS MON DN 400MM @ 210TH ST W & AVE F 36M S/O CONC STRIP OF LA AQUEDUCT MKD (30,29,31,32,T8N, R15W,RE 2177) MKR POST 600MM NW/O MON	L 4604
LANCASTER-W (1998)	0960.450 3151.076	CS MON FL @ C/L INT 210TH ST W & AVE F-8 30.5M E/O PP (NO#) 5.5M E/O C/L DIRT RD MKD (1/4 COR 31,32,R15W,T8N,RE 2177) MKR POST 300MM SE/O MON	L 4605
LANCASTER-W (1998)	0961.004 3152.894	50MM IP W/CONC PLUG & CS TAG 100MM UP @ C/L 210TH ST W & 12M S/O C/L AVE F-8 33M SE/O PP (NO#) 5.5M E/O C/L DIRT RD	L 4606
LANCASTER-W (1998)	0965.926 3169.042	100MM IP W/BRASS CAP UP 450MM 1M E/O C/L INT AVE G & 210TH ST W 1.5M E/O PP (NO#) 6M E & 4M S/O C/O DIRT RDS MKD (FOREST RESERVE BOUNDARY POST #68)	L 4608

UAD-YEAR	ELEV METER/FOOT	D E S C R I P T I O N (INCLUDE QUAD AND YEAR IN DESCRIPTION)	BM NUMBER
LANCASTER-W (1998)	1002.470 3288.937	L&T IN CONC WALL W SIDE OF DRWY TO HSE #15003 ELIZABETH LAKE RD 9.4M N/O C/L & 110M SELY/O C/L INT HUNGRY JACK RD	L 4709
LANCASTER-W (1998)	1006.759 3303.008	RDBM MON IN WELL 1M BELOW SURFACE 12.5M W C/L MUNZ RANCH RD & 34.4M N/O C/L ELIZABETH LAKE RD 3.7M SW/O GTE 1M TALL ELEC BOX	L 4710
LANCASTER-W (1998)	0988.011 3241.499	RDBM TAG IN SLY HDWL 6M ELY C/L MUNZ RANCH RD & 885M N/O ELIZABETH LAKE RD 29M SLY PP #307253	L 4711
LANCASTER-W (1998)	0853.289 2799.499	RDBM MON FLUSH 15M NWLY/O C/L MUNZ RANCH RD & 3.4K N/O ELIZABETH LAKE RD 76M NE/O MI MKR #2.30 MKR POST 600MM ELY/O MON	L 4713
LANCASTER-W (1998)	0835.588 2741.425	CSBM MON FLUSH 10.7M WLY C/L MUNZ RANCH RD & 4K N/O ELIZABETH LAKE RD & 1.5M N PP #294508E MKD (BM 113-5A 1976 RE 22726) MKR 600MM E/O MON	L 4714
LANCASTER-W (1998)	0779.767 2558.286	RDBM TAG @ S END HDWL 7.6M N/O C/L DIRT DR TO HSE #45740 MUNZ RANCH RD 8.5M E/O C/L & 134M S C/L LANCASTER RD MKD (BM)	L 4715
LANCASTER-W (1998)	1008.556 3308.904	CSBM MON IN W END HDWL NR MI MKR #18.13 5.5M N C/L ELIZABETH LAKE RD & 1.05K W/O MUNZ RANCH MKD (BM 111-33B 1972 RE 7078)	L 4716
LANCASTER-W (1998)	0994.629 3263.212	RDBM TAG IN E EDGE OF CONC DRWY ENT TO PINE CYN CO FIRE STA 13M N/O ELIZABETH LAKE RD & 805M E/O MOUNTAIN VIEW RD 6.7M NW/O PP #110-74	L 4717
LANCASTER-W (1998)	0988.527 3243.192	USC&GS MON @ S END OF E WING WALL @ MILE MKR #19.99 9M S/O C/L ELIZABETH LAKE RD & 12M E/O C/L MOUNTAIN VIEW RD MKD (R 975 RESET 1967)	L 4718
LANCASTER-W (1998)	0988.547 3243.258	LACS TAG IN NW COR WALK ON BRIDGE #1686 @ MI MKR #19.99 6M N/O C/L ELIZABETH LAKE RD & 7.6M E/O C/L INT MOUNTAIN VIEW RD	L 4719
LANCASTER-W (1998)	0987.613 3240.194	L&T IN NE COR CONC DR TO HSE #17826 ELIZABETH LAKE RD 8.8M S/O C/L & 73M E/O NOBLETT DR	L 4720
LANCASTER-W (1998)	0989.113 3245.115	CS MON IN WELL 300MM DN @ OR NEAR C/L INT LAKE HUGHS RD & ELIZABETH LAKE RD MKD (RE 5869)	L 4721
LANCASTER-W (1998)	0776.541 2547.702	CS MON 450MM DN 1M N C/L PROD AVE I & 12M E/O C/L PROD 120TH ST W 17M SE/O PP #2109621E MKD (10,11,15,14,R14W,T7N,RE 2177)	L 4722

JAD-YEAR	ELEV METER/FOOT	D E S C R I P T I O N (INCLUDE QUAD AND YEAR IN DESCRIPTION)	BM NUMBER
LANCASTER-W (1998)	0849.125 2785.838	CALIF DIV OF HWYS MON 300MM DN 11M E/O C/L LANCASTER RD (167TH ST W) & 120M S/O C/L PROD AVE F-8 22.6M S/O PP #1955042E MKD (BM 2786 RM 2 1972) MKR POST 750MM S/O MON	L 4725
LANCASTER-W (1998)	0876.305 2875.011	L&T IN E END OF HDWL 7M S/O CTR OF TRAVELED LANCASTER RD (CURVE) & 35M W/O C/L PROD 190TH ST W NR C/L PROD AVE F	L 4726
LANCASTER-W (1998)	0875.974 2873.925	L&T IN E END OF HDWL 11M N/O CTR OF TRAVELED LANCASTER RD (CURVE) & 22.6M W/O C/L PROD 190TH ST W 16M N/O C/L PROD AVE F	L 4727
LANCASTER-W (1998)	0769.419 2524.335	CS MON IN WELL 360MM DN @ C/L INT AVE A & (FUT) 125TH ST W MKD (1/4 COR 34,3,T8N,T9N,R14W)	L 4728
LANCASTER-W (1998)	0789.012 2588.617	CS MON FL 14M E & 14M N/O C/L INT AVE A & FUT 150TH ST W MKD (FAIRMONT BUTTE M-7 RM-1 1970 RE 5869) MKR POST 1.5M S/O MON	L 4730
LANCASTER-W (1998)	0791.214 2595.841	CS MON IN WELL 380MM DN @ FUT 155TH ST W & AVE A MKD (1/4 COR T9N,T8N,R14W,SEC 6,31,RE 2177)	L 4731
LANCASTER-W (1998)	0795.900 2611.215	CS MON IN WELL 370MM DN @ C/L INT FUT 165TH ST W & AVE A MKD (1/4 SEC 36,1,T8N,T9N,R15W,RE 5869)	L 4732
LANCASTER-W (1998)	0801.158 2628.466	CS MON 300MM DN @ C/L INT AVE A & FUT 175TH ST W 21M SW/O PP #1875601E & 43M SW/O PP #1870500E MKD (1/4 SEC COR 35,2,T9N,T8N,R15W,RE 5869)	L 4733
LANCASTER-W (1998)	0781.653 2564.473	RDBM TAG IN SE COR TELEPHONE VAULT 12.5M W & 18M N/O C/L 140TH ST W & (FUT) AVE C-8	L 4734
LANCASTER-W (1998)	0777.431 2550.622	RDBM TAG IN N EDGE CONC AROUND WATER M H 9M W & 15M S/O C/L 140TH ST W & (FUTURE) AVE B-8	L 4735
LANCASTER-W (1998)	0778.759 2554.978	CS MON IN WELL 530MM DN @ C/L INT AVE B & 140TH ST W MKD (SEC 5,4,8,9,T8N,R14W)	L 4736
LANCASTER-W (1998)	0779.786 2558.348	CS MON IN WELL 530MM DN @ INT 140TH ST W & (FUT) AVE A-8 MKD (1/4 COR SEC 4,5,T8N,R14W)	L 4737
LANCASTER-W (1998)	0841.233 2759.945	CS MON FLUSH 15M S & 19M W/O C/L INT TRAVELED ROADWAYS 170TH ST W & AVE E-8 (DIRT RD) MKD (FAIRMONT BUTTE RM-1 I 15 1971 RE 5869)	L 4739
LANCASTER-W (1998)	0841.159 2759.702	CS MON FLUSH 15M N & 19M W/O C/L TRAV ROADWAYS 170TH ST W & AVE E-8 (DIRT ROAD) MKD (FAIRMONT BUTTE I 15, RM 2, 1971, RE 5869) MKR 600MM N/O MON	L 4740

UAD-YEAR	ELEV METER/FOOT	DESCRIPTION (INCLUDE QUAD AND YEAR IN DESCRIPTION)	BM NUMBER
LANCASTER-W (1998)	0817.692 2682.711	CSBM MON FL 17M E/O C/L 170TH ST W (TRAVELED) & 44.5M N/O AVE C-8 (FUT) MKD (BM 117-37A RE 22726 1976) MKR POST 600MM SW/O MON	L 4743
LANCASTER-W (1998)	0837.470 2747.599	CS MON IN WELL 300MM DN @ C/L INT 190TH ST W & FUT AVE C-8 MKD (1/4 COR 15,16,T8N,R15W,RE 2177) 2.4M W/O CTR TRAV RDWY & 6.5M S/O C/L DIRT RD	L 4744
LANCASTER-W (1998)	0822.431 2698.259	CS MON IN WELL 600MM DN @ C/L INT 190TH ST W & AVE B-8 MKD (T8N R15W 1/4 SEC 9,10,RE 2177) 1.5M W/O TRAVELED RD WAY & 805M N/O AVE C	L 4745
LANCASTER-W (1998)	0814.753 2673.069	RDBM MON IN WELL 150MM DN 14M S & 11M E/O C/L INT 190TH ST & AVE B 1M E/O PP #2038656E MKD (1981) MKR POST 600MM E/O MON	L 4746
LANCASTER-W (1998)	1030.739 3381.683	RDBM MON 13M N C/L LANCASTER RD & 60M E/O C/L INT OLD RIDGE RTE RD 1.5M N/O PP #1061954E MKD (1981)	L 4747
LANCASTER-W (1998)	1030.437 3380.692	RDBM TAG IN CTR OF CONC HDWL TO CULV 17M S/O C/L LANCASTER RD & 17M E/O C/L OLD RIDGE RTE RD (FROM MC OF CURVE) 32M W/O GUY POLE #1061955E	L 4748
LANCASTER-W (1998)	1212.446 3977.833	RDBM TAG IN TOP OF STONE & MORTAR GATE COR POST 1M UP ON W SIDE OF DRWY TO HSE #28963 PINE CYN RD 6M N/O C/L & 4K W/O THREE POINTS RD	L 4749
LANCASTER-W (1998)	1015.904 3333.012	RDBM TAG IN W CB 6000MM S/O W END IN W MOST ENT TO HSE #68 CIRCLE K RANCH 16.5M S C/L LANCASTER RD & 1.8K W/O OLD RIDGE RTE RD	L 4750
LANCASTER-W (1998)	1013.675 3325.699	RDBM TAG IN CTR OF HDWL #108+17 11.3M S/O C/L LANCASTER RD & 2.1K W/O OLD RIDGE RTE RD	L 4751
BASELINE (1998)	1015.163 3330.581	DPW BM TAG IN E END CONC WALK (600MM FR END) @ SW COR ELIZABETH LAKE RD & JOHNSON RD 22M W & 17.7M S/O C/L INT	L 4934
BASELINE (1998)	0934.975 3067.497	CS BR CAP IN SE END CONC WINGWALL CULV #11.47 9.4M S/O C/L JOHNSON RD & 2.7K E/O LIMERIDGE DR MKD (BM 119-30A 1976) IP MKR 600MM E/O MON	L 4935
BASELINE (1998)	0870.724 2856.700	DPW BM TAG IN WELL 10M SE/O C/L MOC JOHNSON RD & 110TH ST W 9.4M W C/L PROD 110TH ST W 900MM S/O PP #2109688E MKD (BM 1990) IP MKR 1M W MON	L 4936
BASELINE (1998)	1013.270 3324.370	L&T IN S END CONC HDWL 4.5M E/O C/L ELIZABETH LAKE RD & 101M S/O C/L JOHNSON RD	L 5591

UAD-YEAR	ELEV METER/FOOT	D E S C R I P T I O N (INCLUDE QUAD AND YEAR IN DESCRIPTION)	BM NUMBER
BASELINE (1998)	1060.183 3478.284	LACO BM TAG IN E END CONC HDWL 4.7M N/O C/L JOHNSON RD & 32M E/O C/L DRWY TO HSE #12601 @ MI MKR #12.54	L 5592
BASELINE (1998)	0899.721 2951.835	CSBM MON IN SLY END CONC HDWL 19M N/O C/L JOHNSON RD & 6.3M W/O C/L ENT TO AQUEDUCT 644M W/O 110TH ST W	L 5593
BASELINE (1998)	0889.468 2918.196	DWR MON DN 200MM 9M SLY C/L JOHNSON RD & 483M W/O 110TH ST W 17M S/O PP #2109682E MKD (M3-159 1968) MKR PIPE 300MM N/O MON	L 5594
LANCASTER-W (1998)	0759.114 2490.527	50MM IP W/CONC PLUG & DPW BM TAG @ SW COR AVE A & 110TH ST W 16M S & 11.5M W/O C/L INT 1.5M W/O PP #1222730	L 5652
LANCASTER-W (1998)	0759.483 2491.737	DPW BM TAG IN TOP OF 1M CONC IRRIGATION VALVE N SIDE 1.2M UP @ SE COR 110TH ST W & AVE B 17.6M S & 18.6M E/O C/L INT	L 5653
LANCASTER-W (1998)	0761.893 2499.644	CSBM MON FL @ SW COR 110TH ST W & AVE G 42.5M S & 9M W/O C/L INT MKD (BM 119-20 1961 RE 5869) MKR POST 600MM E/O MON	L 5654
LANCASTER-W (1998)	0762.949 2503.109	CS MON FL IN CONC PAD 13M W/O C/L 110TH ST W & 177M S/O AVE G-8 32M S/O PP #1222554 MKD (DEL SUR G 4A 1968 RE 5869) MKR 1.6M E/O MON	L 5655
LANCASTER-W (1998)	0762.835 2502.734	USC&GS MON IN CONC PAD 150MM DN 9M E C/L 110TH ST W & 185M S/O AVE G-8 MKD (POLE NO.1 1932) MKR POST 300MM S/O MON	L 5656
LANCASTER-W (1998)	0762.241 2500.786	50MM IP W/CONC PLUG & DPW BM TAG @ SW COR AVE H & 110TH ST W 12.5M S & 12.7M W/O C/L INT 1.5M W/O PP #1222543	L 5657
LANCASTER-W (1998)	0773.816 2538.761	USC&GS MON FL IN CONC PAD @ SW COR 110TH ST W & AVE J 15M S & 16.2M W/O C/L INT MKD (SUR 2 1968) MKR POST 1.2M N/O MON	L 5658
LANCASTER-W (1998)	0774.381 2540.615	USC&GS MON FL IN CONC PAD @ SW COR 110TH ST W & AVE J 29.4M S & 16.6M W/O C/L INT MKD (SUR 2 NO.4 1968) MKR POST 600MM S/O MON	L 5659
LANCASTER-W (1998)	0818.660 2685.887	DPW BM TAG IN NW COR CONC GTE PAD @ SE COR AVE K & 110TH ST W 39M E & 11.7M S/O C/L INT	L 5660
LANCASTER-W (1998)	0849.032 2785.532	CAL DIV HWY MON FL 563M S/O AVE K & 8M E/O C/L 110TH ST W MKD (DEL SUR G 10 RM 1 1972) MKR POST 600MM S/O MON	L 5661

QUAD-YEAR	ELEV METER/FOOT	D E S C R I P T I O N (INCLUDE QUAD AND YEAR IN DESCRIPTION)	BM NUMBER
LANCASTER-W (1998)	0849.690 2787.691	CAL DIV HWY MON FL 588M S/O AVE K & 16.5M W/O 110TH ST W MKD (DEL SUR G 10 RM 2 1972) MKR POST 600MM S/O MON	L 5662
LANCASTER-W (1998)	0762.424 2501.386	50MM IP W/CONC PLUG & DPW TAG 25MM UP 600MM N/O PP #2175728E @ NE COR AVE I & 110TH ST W 14.4M E & 8.4M N/O C/L INT	L 5789
LANCASTER-W (1998)	1002.687 3289.649	L&T IN N WINGWALL 450MM FROM END @ SE COR ELIZABETH LAKE RD & RANCH CLUB RD 21.5M S & 11M E/O C/L INT	L 5973
LANCASTER-W (1998)	1003.071 3290.909	DPW BM TAG IN SE COR OF CONC DRWY APRON TO HSE #15031 ELIZABETH LAKE RD 6M N C/L & 33.6M E/O C/L HUNGRY JACK DR	L 5974
LANCASTER-W (1998)	1008.774 3309.619	50MM IP W/CONC PLUG & DPW BM TAG 300MM W/O PP #1698942E 7.5M N/O C/L ELIZABETH LAKE RD & 724M W/O MUNZ RANCH RD 11M W/O MI MKR #17.81	L 5975
LANCASTER-W (1998)	0897.353 2944.066	USC&GS BM MON @ W END SLY HDWL 6M N C/L ACCESS RD CALIF AQUEDUCT & 33M E/O C/L MUNZ RANCH RD MKD (T 1221 1971) 2.6K N/O ELIZABETH LAKE RD	L 5976
LANCASTER-W (1998)	0897.082 2943.177	DPW BM TAG IN W END NLY HDWL 6M N/O C/L ACCESS RD CALIF AQUEDUCT & 33M E/O C/L MUNZ RANCH RD 2.6K N/O ELIZABETH LAKE RD	L 5977
LANCASTER-W (1998)	0769.434 2524.385	50MM IP W/CONC PLUG & DPW BM TAG 600MM E/O PP #2175742E @ NW COR AVE I & 115TH ST W 24M W & 8.5M N/O C/L INT	L 5978
LANCASTER-W (1998)	0839.370 2753.833	50MM IP W/CONC PLUG & DPW BM TAG 1.4M E/O GUY POLE 9M N/O C/L LANCASTER RD & 4.6K W/O MUNZ RANCH RD 5M E/O C/L DIRT RD TO N	L 5979
LANCASTER-W (1998)	0862.128 2828.498	50MM IP W/CONC PLUG & DPW BM TAG 400MM W/O PP (NO#) 7.6M S C/L LANCASTER RD & 28M E/O C/L 160TH ST W	L 5980
LANCASTER-W (1998)	0863.261 2832.215	CS MON 450MM DN 6M W C/L 160TH ST W & 600MM N/O C/L LANCASTER RD MKD (1/4 COR 1,6,T7N,R14W,RE 2177) MKR POST 1M SW/O MON	L 5981
LANCASTER-W (1998)	0850.001 2788.712	50MM IP W/CONC PLUG & DPW BM TAG 1M W PP (NO#) 161M W/O 160TH ST W PROD & 8M NLY C/L LANCASTER BLVD	L 5982



UAD-YEAR	ELEV METER/FOOT	D E S C R I P T I O N (INCLUDE QUAD AND YEAR IN DESCRIPTION)	BM NUMBER
LANCASTER-W (1998)	0854.542 2803.610	CAL DIV HWYS BM MON 7.3M NLY/O C/L LANCASTER RD & 161M E/O 167TH ST W 14M E/O PP (NO#) WITH GUY POLE MKD (011)	L 5983
LANCASTER-W (1998)	0846.244 2776.386	50MM IP W/CONC PLUG & DPW BM TAG FLUSH 7M E/O C/L 170TH ST W NR C/L PROD AVE F	L 5984
LANCASTER-W (1998)	0834.233 2736.979	50MM IP W/CONC PLUG & DPW BM TAG FLUSH 1M N/O ARROW HWY SIGN MKR @ SE COR 170TH ST W & AVE E 12M E & 1M S/O C/L INT	L 5985
LANCASTER-W (1998)	0827.118 2713.636	50MM IP W/CONC PLUG & DPW BM TAG 10M W/O C/L 170TH ST W 805M S/O AVE D @ AVE D-8 MKR POST 300MM E/O MON	L 5986
LANCASTER-W (1998)	0820.750 2692.744	CSBM MON 2M NW/O PP #1312398E @ NW COR AVE D & 170TH ST W 10M N & 48M W/O C/L INT MKD ( BM 117 -38B 1972 RE 7078)	L 5987
LANCASTER-W (1998)	0821.079 2693.823	50MM IP W/CONC PLUG & DPW BM TAG 1M E PP (NO#) @ SW COR 170TH ST W & AVE D 9M S & 52M W C/L INT	L 5988
LANCASTER-W (1998)	0883.114 2897.350	DPW BM TAG IN NW COR CONC MAIL BOX PAD 10M E/O C/L PROD 190TH ST W & 15.5M N/O C/L PROD AVE F-8 (LANCASTER RD)	L 5989
LANCASTER-W (1998)	0885.540 2905.309	50MM IP W/CONC PLUG & DPW BM TAG FLUSH 15M N C/L AVE LANCASTER RD (AVE E-15) & 805M W/O 190TH ST W MKR POST 600MM N/O MON	L 5990
LANCASTER-W (1998)	0900.000 2952.750	50MM IP W/CONC PLUG & DPW BM TAG FLUSH 26M N C/L LANCASTER RD (AVE E-15) & 4.3M W C/L 200TH ST W (DIRT RD) 1.4M N/O ST CALIF P/L BNDRY SIGN	L 5991
LANCASTER-W (1998)	0901.351 2957.182	CS MON 53M S/O C/L LANCASTER RD (AVE E-15) & 23M W/O C/L PROD 200TH ST W MKD (1/4 SEC COR 29 ,28,33,32,R15W,T8N,RE 7078) TWO MKR POST 600MM W & 600MM E/O MON	L 5992
LANCASTER-W (1998)	0879.832 2886.582	50MM IP W/CONC PLUG & DPW BM TAG FLUSH 13M N/O C/L LANCASTER RD (AVE D-15) 1K W/O 210TH ST W 322M E/O 224TH ST W MKR POST 300MM N/O MON	L 5993
LANCASTER-W (1998)	0919.623 3017.130	50MM IP W/CONC PLUG & DPW BM TAG FLUSH 7.4M SW OF C/L LANCASTER RD & 805M W/O 235TH ST W 58M W/O BC OF CURVE FROM E MKR POST 300MM E/O MON	L 5994
LANCASTER-W (1998)	0763.772 2505.809	CAL-TRANS BR DISK MON IN CONC PAD FL @ SW COR AVE D & 115TH ST W (DIRT) 28M S & 41M W/O C/L INT MKD (VOLT NO.2 1983) MKR POST 700MM SW/O MON	L 5995

UAD-YEAR	ELEV METER/FOOT	D E S C R I P T I O N (INCLUDE QUAD AND YEAR IN DESCRIPTION)	BM NUMBER
LANCASTER-W (1998)	0767.394 2517.692	50MM IP W/DPW BM TAG 1M E/O PP #2287951E @ NE COR AVE D & (FUT) 120TH ST W 13M N & 31M E/O C/L INT (15M W/O DIRT RD FOR EDISON TOWERS)	L 5996
LANCASTER-W (1998)	0782.579 2567.511	50MM IP W/DPW BM TAG 1M E/O PP #2287946E @ NE COR AVE D & (FUT) 135TH ST W 13.5M N & 11.5M E/O C/L INT	L 5997
LANCASTER-W (1998)	0786.598 2580.697	DPW BM TAG IN SW COR OF CONC TELE VAULT @ SW COR AVE D & 140TH ST W 11M W & 25.5M S/O C/L INT	L 5998
LANCASTER-W (1998)	0798.598 2620.067	50MM IP W/SPK&W @ SW COR AVE D & 150TH ST W 25M S & 51.5M W/O C/L INT MKD (CAL-TRANS 150D) MKR POST 600MM NE/O MON	L 5999
LANCASTER-W (1998)	0806.952 2647.475	50MM IP W/DPW BM TAG FL 400MM S/O PP #1219170E @ NE COR AVE D & 160TH ST W 13M N & 11M E/O C/L INT	L 6000
LANCASTER-W (1998)	0827.963 2716.409	CAL-TRANS MON FL 10M N/O PP #1312387E @ NW COR AVE D & 175TH ST W 23.5M N & 2M W/O C/L INT MKD (FAIRMONT BUTTES H-12 RM 1 1972) MKR POST 800MM NW/O MON	L 6001
LANCASTER-W (1998)	0834.228 2736.963	50MM IP W/DPW BM TAG FL 1.5M S/O PP (NO#) @ SE COR AVE D & 180TH ST W 16M E & 10.4M S/O C/L INT	L 6002
LANCASTER-W (1998)	0840.454 2757.389	DPW BM TAG IN SE COR CONC SIGN PAD @ SE COR AVE D & 185TH ST W 18.3M S & 4.6M E/O C/L INT	L 6003
LANCASTER-W (1998)	0840.095 2756.212	50MM IP W/DPW BM TAG FL 2M E/O PP #1312363E @ NW COR AVE D & 185TH ST W 14M N & 4M W/O C/L INT MKR POST 450MM N/O MON	L 6004
LANCASTER-W (1998)	0845.969 2775.483	50MM IP W/DPW BM TAG FLUSH 1M E/O PP #1871481E 13M N/O C/L AVE D & 21M E/O C/L 190TH ST W	L 6005
LANCASTER-W (1998)	0849.115 2785.805	CAL-TRANS MON 534M W/O 190TH ST W & 10.5M S/O C/L AVE D MKD (FAIRMONT BUTTES D-13 1972) MKR POST 1M E/O MON	L 6006
LANCASTER-W (1998)	0848.467 2783.679	CAL-TRANS MON FL 536M W/O 190TH ST W & 9M N/O C/L AVE D MKD (FAIRMONT BUTTES D-13 RM-2 1972) MKR POST 1M E/O MON	L 6007
LANCASTER-W (1998)	0854.907 2804.807	50MM IP W/DPW BM TAG FL 1M E/O PP #1312328E @ NE COR AVE D & 200TH ST W 13M N & 11.5M E/O C/L INT	L 6008

JAD-YEAR	ELEV METER/FOOT	D E S C R I P T I O N (INCLUDE QUAD AND YEAR IN DESCRIPTION)	BM NUMBER
LANCASTER-W (1998)	0860.665 2823.698	CAL-TRANS MON 370M W/O 200TH ST W & 10.4M N/O C/L AVE D MKD (FAIRMONT BUTTES A-13 RM-1 1972) MKR POST 800MM W/O MON	L 6009
LANCASTER-W (1998)	0861.019 2824.860	CAL-TRANS MON FL 372M W/O 200TH ST W & 10.4M S/O C/L AVE D MKD (FAIRMONT BUTTES A-13 1972) MKR POST 1M W/O MON	L 6010
LANCASTER-W (1998)	0859.916 2821.241	50MM IP W/DPW BM TAG FL 1M W/O PP #1120417E @ NE COR AVE D & 215TH ST W (DIRT RD N) 17M E & 8M N/O INT	L 6011
LANCASTER-W (1998)	0858.108 2815.309	50MM IP W/DPW BM TAG FL 2M E/O PP #2287797E @ NW COR AVE D & 220TH ST W 16M W & 10M N/O C/L INT (E/O MI MKR #17.0)	L 6012
LANCASTER-W (1998)	0858.371 2816.172	50MM IP W/DPW BM TAG FL 1.4M E/O PP #2287796E 87M W/O C/L 220TH ST W & 10M N/O C/L AVE D	L 6013
LANCASTER-W (1998)	0878.742 2883.006	50MM IP W/DPW BM TAG FL 1M W/O PP #1120460E @ NW COR AVE D & 235TH ST W 9M N & 2M W/O C/L INT	L 6014
LANCASTER-W (1998)	0871.504 2859.259	50MM IP W/DPW BM TAG FLUSH @ SW COR 210TH ST W & AVE D-8 14.5M W & 7.5M S/O C/L INT	L 6015
LANCASTER-W (1998)	0782.200 2566.268	DPW BM TAG IN E CB OF VAULT @ SW COR AVE A & 140TH ST W 18M S & 22M W/O C/L INT	L 6016
LANCASTER-W (1998)	0791.508 2596.806	CSBM MON FL @ SW COR AVE A & 155TH ST W 26M W & 12.6M S/O C/L INT MKD (BM 117-29 RE 5869 1961) MKR POST 600MM E/O MON	L 6017
LANCASTER-W (1998)	0798.037 2618.226	CS MON IN WELL 310MM DN @ C/L INT AVE A & 170TH ST W MKD (SEC COR 35,36,2,1,T8N,R15W,RE 5869)	L 6018
LANCASTER-W (1998)	0780.303 2560.044	DPW BM TAG IN CTR E CB AROUND WATER WELL @ SE COR 140TH ST W & AVE A-8 13.6M S & 23M E C/L INT	L 6019
LANCASTER-W (1998)	0814.154 2671.104	50MM IP W/DPW BM TAG FLUSH 26M N/O C/L FUTURE AVE C (DIRT RD W) & 10M W/O C/L 170TH ST W MKR POST 1M E/O MON	L 6020
LANCASTER-W (1998)	0800.563 2626.514	50MM IP W/DPW BM TAG FLUSH @ NW COR 170TH ST W & AVE B 11.6M W & 8.6M N/O C/L INT (TRAV RDS) 600MM E/O (NOT A THROUGH ST SIGN)	L 6021
LANCASTER-W (1998)	0852.981 2798.488	50MM IP W/DPW BM TAG 1M E/O PP (NO#) 15M S/O C/L DIRT RD (FUT AVE D-8) & 9M E/O C/L TRAVELED RD 190TH ST W 805M S/O AVE D	L 6022

UAD-YEAR	ELEV METER/FOOT	DESCRIPTION (INCLUDE QUAD AND YEAR IN DESCRIPTION)	BM NUMBER
LANCASTER-W (1998)	0929.506 3049.554	DPW BM TAG IN CONC 8M S C/L LANCASTER RD & 2.4M W/O C/L DIRT RD TO S 322M E/O THREE POINTS RD 4.5M NE/O NE FENCE COR	L 6023
LANCASTER-W (1998)	0929.219 3048.613	50MM IP W/DPW BM TAG FL 1M E/O PP #1123619E @ NE COR LANCASTER RD & THREE POINTS RD 23M E & 8.5M N/O C/L INT	L 6024
LANCASTER-W (1998)	0921.608 3023.642	DPW BM TAG IN E END HDWL 42M E/O C/L BARNES RANCH RD & 6.5M SLY/O LANCASTER RD (HWY 138)	L 6025
LANCASTER-W (1998)	0921.091 3021.946	DPW BM TAG 1.5M W/O E END HDWL 37.5M E/O C/L BARNES RANCH RD & 11M NLY/O C/L LANCASTER RD (HWY 138)	L 6026
LANCASTER-W (1998)	0925.369 3035.981	DPW BM TAG IN SW COR CONC ELEC BOX SLAB @ NE COR 280TH ST W & LANCASTER RD (HWY 138) 35M E & 12.4M N/O C/L INT	L 6027
LANCASTER-W (1998)	0952.604 3125.335	DPW BM TAG IN CONC CB FLUSH 1M W/O E END 15.6M S C/L LANCASTER RD (HWY 138) 7.6M E/O N&S PP LINE 31M S/O PP #1950487E	L 6028
LANCASTER-W (1998)	1030.738 3381.680	DPW BM TAG IN CTR OF WINGWALL CULV 9M S C/L LANCASTER RD (HWY 138) & 26M E/O C/L GATE TO DITR RD @ E SIDE OF BLDG #33628	L 6029
LANCASTER-W (1998)	0930.875 3054.046	CS BRASS CAP IN CTR OF CONC STRIP LA AQUEDUCT 8M E/O C/L DIRT RD (210TH ST W) & 5.5M SW/O METAL FENCE COR MKD (SEC 29,30,T8N,R15W,1986)	L 6030
LANCASTER-W (1998)	1046.344 3432.880	LACO BM TAG IN LOWER CONC PORCH SLAB @ BLDG # 26486 SW COR THREE POINTS RD & PINE CYN RD 15M W & 11M S/O C/L INT	L 6031
LANCASTER-W (1998)	1057.424 3469.232	50MM IP W/DPW BM TAG FL 300MM N/O WLY PP STUB @ NE PROP COR HSE #27012 PINE CYN RD 6M S/O C/L & 805M W/O THREE POINTS RD	L 6032
LANCASTER-W (1998)	1158.482 3800.786	DPW BM TAG IN LRG ROCK 5.5M S/O C/L PINE CYN RD 10M W/O 1.5M OAK TREE 16M E/O 2 WOOD POST ENT TO DIRT TRAIL	L 6033
LANCASTER-W (1998)	1159.005 3802.502	50MM IP W/DPW BM TAG FLUSH 300MM N/O ELY POST GATED ENT TO HSE #30100 PINE CYN RD 8M S/O C/L	L 6034
LANCASTER-W (1998)	1118.310 3668.989	DPW BM TAG IN CONC FTG OF WIRE MESH FENCE POST 9M SWLY OF C/L DRWY TO 31008 PINE CYN RD 10M WLY/O C/L	L 6035

JAD-YEAR	ELEV METER/FOOT	DESCRIPTION (INCLUDE QUAD AND YEAR IN DESCRIPTION)	BM NUMBER
LANCASTER-W (1998)	1176.197 3858.906	50MM IP W/DPW BM TAG FLUSH 1M N/O PP (NO#) 17M N/O C/L ENT TO HSE #32633 PINE CYN RD 4.6M W/O C/L	L 6036
LANCASTER-W (1998)	1012.022 3320.276	USC&GS MON FLUSH 8.5M S/O C/L GORMAN POST RD & M E/O CONNECTOR RD WITH LANCASTER RD (HWY 138) MKD (S 973 1964) MKR SIGN 600MM W/O MON	L 6037
LANCASTER-W (1998)	1012.955 3323.337	USC&GS MON FLUSH 8.5M S/O C/L GORMAN POST RD & 93M E/O CONNECTOR INT WITH LANCASTER RD (HWY 138) MKD (R 973 1964) MKR SIGN 600MM W/O MON	L 6038
LANCASTER-W (1998)	1013.891 3326.407	USC&GS MON FLUSH 9M S/O C/L GORMAN POST RD & 43M E/O CONNECTOR INT WITH LANCASTER RD (HWY 138) MKD (Q 973 1964) MKR SIGN 600MM W/O MON	L 6039
LANCASTER-W (1998)	1014.849 3329.550	USC&GS MON FLUSH @ SW COR OF CONNECTOR RD FROM LANCASTER RD (HWY 138) & GORMAN POST RD 9M S & 11.6M W/O C/L INT MKD (P 973 1964) MKR SIGN 600MM W/O MON	L 6040
LANCASTER-W (1998)	1114.432 3656.266	CA DIV HWYS MON 2.5M S/O PP (NO#) 12M N/O C/L GORMAN POST RD & 1.6K E/O GORMAN SCHOOL RD IN MIDDLE OF THREE MKR POST MKD (LEBEC E-10 1973)	L 6041
LANCASTER-W (1998)	1163.309 3816.623	DPW BM TAG IN N CB @ F HYD 12.5M E/O C/L PROD GORMAN SCHOOL RD & 12M N/O C/L GORMAN POST RD	L 6042
LANCASTER-W (1998)	1164.047 3819.044	DPW BM TAG IN W CB 9.5M S/O BCR @ SW COR GORMAN POST RD & GORMAN SCHOOL RD 10M W & 21.4M S/O C/L INT	L 6043
LANCASTER-W (1998)	1275.279 4183.978	CAL-TRANS MON IN NW COR OF BRIDGE OVER (5 FRWY) 4.3M N C/L BRIDGE & 18M ELY C/L PEACE VALLEY RD MKD (LA 05 PM 87.37 LS 4965 1992)	L 6044
LANCASTER-W (1998)	1216.857 3992.305	DPW BM TAG IN CONC DROP INLET ON C/L ISLAND PEACE VALLEY RD @ MI MKR #0.70 N END INT	L 6045
LANCASTER-W (1998)	1196.959 3927.023	CSBM DISK IN HDWL 1.4M S/O N END 11M S/O C/L W LANES PEACE VALLEY RD & 563M S/O FRAZIER MTN PARK RD @ MI MKR 0.35 MKD (102-110 1968 RE 5869)	L 6046
LANCASTER-W (1998)	1169.795 3837.902	DPW BM TAG IN W CB N END C B 1.4M S/O BCR @ SW COR PEACE VALLEY RD & FRAZIER MTN PARK RD 26M S & 10M W/O C/L INT	L 6047
LANCASTER-W (1998)	1167.518 3830.432	BRASS CAP MON IN CONC 300MM DN @ NE COR FRAZIER MTN PARK RD & LEBEC RD 19M N & 12M E/O C/L INT MKD (LA/KERN CO BNDRY)	L 6048